

# THE PICK & SHOVEL



The Official Publication of the

Lincoln Gem &  
Mineral Club, Inc.

In association with



The Midwest Federation of  
Mineralogical and  
Geological Societies



The American  
Federation of  
Mineralogical Societies

The purpose of this corporation shall be to study, promote an interest in, and disseminate knowledge of lapidary and various Earth Sciences including but not necessarily limited to Geology, Paleontology and Mineralogy. It shall be a particular purpose of the corporation to provide education in these fields to its members and the general public, especially to youth and student groups.

**GENERAL MEETINGS**

NO IN-PERSON MEETINGS UNTIL FURTHER NOTICE. LINCOLN PARKS & RECREATION HAS CLOSED DOWN BETHANY PARK SHELTER HOUSE UNTIL FURTHER NOTICE, DUE TO COVID-19.

**2021 DUES**

If you were a paid member in 2020, DO NOT PAY DUES FOR 2021. 2020 memberships have automatically rolled over to 2021, due to the pandemic and lack of club activities.

**BOARD MEETINGS**

Until further notice, Board Meetings will be held at 6:30 on the first Thursday of each month.

Meetings are open to all members. If you are interested in attending via Zoom, contact Jim Marburger for the log-in information. You can attend Zoom meetings via computer, tablet, smart phone, or regular telephone. You are not required to use the video option; you may use voice only if desired.

**Next Board Meeting:  
Thursday, April 1, 2021 at 6:30 p.m.  
(via Zoom)**

**MARCH BIRTHDAY GREETINGS**

Mrs. Pat Dvorak, Mr. Bob Gritmit, Mr. Jim Marburger,

**ANNUAL SHOW**

**The April Annual Show is CANCELLED due to COVID and the Lancaster County Directed Health Measures.**

**2021 SUMMER SWAP COMMITTEE**

Chairman:..... Corey Beer  
 Vendors:..... Sharon Marburger  
 Finance & Ticket Sales: ..... Jim Atkins, Vera Lyman  
 Floor Chairman: ..... Corey Beer, Jayne Beer  
 Insurance..... Jayne Beer  
 LGMC Club Booth: .....  
 Publicity & Promotion: ..... Jim Marburger  
 Silent Auction: ..... Sharon Marburger  
 Web Master:..... Sharon Marburger  
 Youth Activities: ..... Brett Jurgens, Corey Beer

Would you like to help with the planning of the 2021 Summer Swap? The club has many decisions to make before hosting this first-time event.

We are in need of volunteers to help out at the Swap. Directing traffic, spending time in the Club Booth, and lending a hand wherever help is needed are some of the ways you can help. Please contact Corey Beer or any other Swap Committee member.

**OTHER CLUB EVENTS**

No monthly **Rock Parties** until further notice.

No club-organized **field trips** at this time.

**Zoetis-LPS-GSK Science Fair is changing to the Virtual 2021 Zoetis-LPS-GSK STEAM Fest!** Businesses, organizations & community partners will be asked to provide learning opportunities and information about Science, Technology, Engineering, Arts and Mathematics for students in 5th-8th grades. Students will participate virtually by picking and choosing items of interest. The 2021 Zoetis-LPS-GSK STEAM Fest will be held April 8th-22nd. Learn more at <https://lps.org/steamfest>! No word at this time if LGMC will be participating.

**Summer Rock Swap:** Find information on pages 7, 8, and 9..

The Spring MWF meeting  
has been cancelled.

See schedule of events on page 10 for the  
2021 National Show in Big Piney, Wyoming  
on June 16 - 22.

All articles, tidbits, and photos not individually identified as being contributed to this publication are provided by the Editor.

## PRESIDENT'S MESSAGE

by Charles "Woolly" Wooldridge

It looks like March is coming in like a lamb; we'll see if it goes out like a lion. I was able to get out in the field the last Tuesday of February. My friend, Tom, and I went out on a stream in the northern Sandhills. It was in the sixties and felt like heaven after the extended cold weather. I found a pot bellied rhino hip socket among other things. It sure felt good to get out!



While up north, the local radio was celebrating National FFA (Future Farmers of America, for you urban folk). I heard a young man exclaim how proud he was of that patch on his blue jacket. I was reminded of a time a number of years ago when the club still had it's show at the Pershing Center. I was tasked with helping a little old lady with the elevator and sitting with her until a taxi could pick her up. I had never paid this woman the time of day, but as I visited with her, I was amazed and intrigued as the stories of her long life were revealed to me. She was such a strong woman although physically weakened by her many years. She told me stories of her early pioneer life as a child, the effort it took for a young woman to be educated, and the perseverance of a woman working for the University of Nebraska. I learned so much from her in just a half an hour! Probably the most important lesson was that I can learn from people that I can see no immediate connection with. Oh, and what does that have to do with the kid that was so proud of wearing that FFA patch? Adeline Nolde, the woman I sat with, developed that patch! She left a lasting legacy.

Be sure to check out the March issue of Rock and Gem magazine. It has a picture on page 29 of our Mineral Monkeys making gem trees. Rock and Gem has really developed into an important resource for our hobby. I encourage you to check it out if you haven't already.

Rock on and stay safe.

## HISTORY OF THE GEM SCOOP

by Charles Wooldridge

Estwing Tools used to manufacture a tool called the Gem Scoop. I have relied on one for many years. Other than water, I consider it to be the most important thing I take on a rock or fossil expedition. The scoop comes in two lengths; 36 inches (right) and 42 inches (left). I use the 36 inch because it also serves as a cane. The 42 inch is more like a walking stick. It has so many uses! I use it, of course, to pick up things I



(Continued on page 4)

## TUCSON REPORT

by Eric Fritzsch, LGMC Friend

I went down to Tucson for six days and most of the shows were cancelled. I had tickets going back to September and could have cancelled them but decided to keep them right up until the day of departure. I checked with a few dealers ahead of time to find out who was going to be around to find out if it would be worthwhile to go. I could just go down for the warm weather, but it wasn't that warm this year. It snowed the day before I got there.

Mineral City is a newer venue on Oracle Street, across the street from Top Gem and the warehouses there that sell minerals (called 1801 Oracle). 1801 Oracle was mostly open and I briefly looked there. Top Gem is open year round but some of the warehouse dealers, like Red Metal Minerals, only come down for the show. Top Gem has some incredible iron cross pyrites replaced by goethite from Columbia. I went through their stock in Denver last fall and picked out seven or eight of them for my collection.

Mineral City is also a group of open small warehouses with overhead garage doors (like storage lockers, but nicer). The dealers there included Leonard Himes, Cal Graber, Dennis Beals, Inter Mountain Minerals, Krystalle, Collectors Edge, Crystal Classics, and others. Shannon Minerals has a building right next door and Midwest Minerals was open with Dave Bunk selling out of a 16x16 corner. The dealers were mostly American, as foreign travel is still very difficult. Some of the dealers ended up subletting from foreign dealers who leased the warehouse space but couldn't use it this year. Shannon had sidewalk repair going on right outside their building, which made it difficult to get inside or advertise where they were located. It took over six days for Shannon to get set up and they weren't set up completely when I left. Mineral City is currently building three or four new buildings for next year. I had the idea about 30 years ago that someone could create a more permanent venue than hotel rooms for mineral dealing.

The shows were very low key and didn't have any people from town wandering around. Parking is limited, but I have never had a problem getting a good spot. Dealer rooms were not very crowded and they tried to enforce crowd size. It was nice to not be bumping elbows, or fighting to get a look at a display case. The dealers were happy; most of the people there were mostly buying. Most of the buyers were internet dealers who couldn't tell a quartz from a calcite. I'm working on a new acronym called NIMCOMPOOPS for Nuevo Internet Mineral Collectors Overtly Massing Pretty, Overpriced, Ordinary, & Piss-poor Specimens (an ode to Rock Carrier). Many of the internet collectors don't label their collections and will soon find out they have no recollection of what they have or where it is from, rendering the collection nearly worthless.

I did pretty well and added about 100 new specimens to my collection. I also purchased a few new gemstones, which is a rapidly growing part of my collection. I usually go down to purchase for my collection and sometimes replace

(Continued on page 4)

**TUCSON FIELD TRIP - CONTINUED***(Continued from page 3)*

specimens. Some of the highlights are a 17 cm tall quartz and hematite after epidote from Bessemer Ridge (Washington), a gemmy wurtzite crystal, and a tourmaline that looks like a steamboat (albite matrix for the boat and two black terminated schorl crystals for the exhaust). The tourmaline isn't as impressive as the Smithsonian's steamboat elbaite, but the one I purchased is a much smaller, blacker, and affordable substitute.

I know that people go to Tucson and all they see are the specimens with \$\$\$\$ on them. Those are fun to look at, but if you look hard enough, you'll find good deals. I bought a specimen of prehnite from Mali which has three green balls of prehnite stacked together from largest to smallest like a 6 cm green snowman. The dealer had this specimen for \$1.50. I think I might make this specimen my Christmas card photo for next year. Perhaps I'll make a small black top hat and scarf for it.

I made sure to be socially distant and didn't spend too much time in dealer rooms or mingling. I always wore a mask, as did most people, and there was plenty of hand sanitizer to go around. I spent my budget in two days and returned a third day to buy a few more specimens that I wanted. I avoided going out to restaurants and was able to do some remote work from my hotel room. I drove out to Ajo to see the New Cornelia Mine. I purchased from Shannon Minerals a real interesting micromount of ilmenite with phillipsite from this location. The mine is heavily fenced off and I didn't want to get arrested for trespassing, so I only looked at the mine and dumps from a distance. The town of Ajo has interesting architecture but it is a slowly dying town.

I also took a trip to the 79 Mine, which is also heavily fenced off with warning signs. I purchased from Dave Bunk a nice blue hemimorphite collected at this mine. With the recent snow and snow melt, the desert was blooming and beautiful.

I spent the rest of my time reading a book I brought with me and packing minerals. I take collapsed boxes, tape, rubber bands, and dry cleaning bags to pack the minerals. It can take about 20 hours to pack up 100 specimens. I inventory them, pack for rough conditions so they can travel back as luggage. No problems getting any of them back. Collectively, my luggage weighed 125 lbs.

Tucson is set to reopen with most of the show promoters having a show April 8 through 20. I suspect that most of the foreign dealers won't be there as travel will still be difficult for them. The changing status of COVID may make for a very different April show. Hopefully, in 2022, it will get back to normal.

The Denver Spring show (which is usually in April) has decided to move this year to May 21. I might see if I can go to that one, perhaps a fly in/fly out trip as it is close to the airport and I won't need a car. Next year, the new Tucson Gem and Mineral Museum will be open and it looks like it will be awesome.

There was a good presentation on Harvard/SMMP/Blue Cap productions this past week on mining feldspar and quartz in Colorado (by Joe Dorris). It often takes them a couple weeks to put it on youtube, but if you check out "blue cap productions" on youtube, they have all sorts of interesting talks on minerals. They are supposed to be releasing one from an interview with Jeff Scovil that I would like to see. Another good talk I heard the other day was by Skip Simmons on tourmaline. This can be downloaded from the Maine Mineral Museum.

**HISTORY OF GEM SCOOP - CONTINUED***(Continued from page 3)*

want to examine. If a stone has dirt, sand or silt on it, instead of licking, I can dip it into a stream and wash it. If water is not to be found close by then, of course, I will lick it. Because of the shape of the cup and because it is made from solid cast aluminum, it can be used to catch a snake, grab onto a shrub or tree to help getting up a slope, dig into the ground to slow and stabilize your descent and, although the manufacturer recommends against using it as a hammer, I have.

For some reason, Estwing stopped production around 1989. A young woman in Colorado was doing quite a bit of rockhounding with her sister who had a Gem Scoop. When she went to get herself one, production had stopped and none were to be had. At the time, she was working for a large international fishing tackle company that did a lot of business with China. She managed to find a company in China that could manufacture them and got permission from Estwing to produce them. The name was changed to Treasure Scoop. When she received them, she contacted @60 gem clubs and offered a discount on parcels of a dozen. This really did not pan out as expected, only a handful of clubs responded. She ended up taking them to the Tucson Show where they did very well. Over time, producing them and marketing got to be too much so she struck a deal with Kingsley North, a well known lapidary supply company in Michigan.

The scoop is listed in the Kingsley North catalog, but when you go to order it, it shows that it is out of stock. For some reason, they quit manufacturing them. I talked with an employee who assured me they would be back in stock this May or June.

There have been other similar devices over the years, but like the "Rock Scooper" on the right in the picture, I have found them inferior in design. Some are made so they can be folded in half which does make them nice for travel. Most are purposed for picking up shells on the beach and just are not sturdy enough for the serious rockhound. However, even a poorly made scoop is better than none at all. Your lower back will affirm this.

## BOARD MEETING MINUTES

Lincoln Gem and Mineral Club, Inc. Board of Directors Meeting February 4, 2021. Meeting held via Zoom teleconferencing. Minutes recorded by Sharon Marburger, Asst. Secretary.

Meeting called to order by First Vice President Jayne Beer at 6:39 p.m. The rules of meeting conduct continue to be suspended, due to COVID-19.

### ROLL CALL

Charles Wooldridge	President	Late Arrival
Jayne Beer	1 VP	Present
Brett Jurgens	2VP	Present
Vera Lyman	Treasurer	Present
James Marburger	Secretary	Present
Corey Beer	Board	Present
Jeff Kubitz	Board	Present
Sharon Marburger	Board	Present
Ed Ridge	Board	Present

The Minutes were sent electronically and read aloud. Motion by Corey to accept the minutes, 2nd by Brett. Passed.

The Treasurer's Report was read. Motion by James to accept the Treasurer's Report, 2nd by Sharon. Passed. Sharon added that the 990-N tax report has been filed. A copy of the report receipt was sent to Vera.

### OLD BUSINESS

Brett reported that we still need to send a box of Nebraska material to the Montana club that sent specimens to the juniors last year. Wooly has provided material for this purpose. All others are encouraged to participate. Jim has offered to provide Odell Diamonds for both the Montana club and the juniors' specimen boxes.

Schramm Park is in need of larger pieces of Nebraska material for its display. Contact Brett with your donations.

There is no new information on the status of the Lapidary Class and its equipment. A location to store the equipment has been secured. Brett will contact Rowdy Cropp to see if they can check on the equipment. In the meantime, Wooly will contact Parks & Recreation regarding the security of the equipment at the Auld Center. Jayne suggested talking to SCC to begin plans for the 2022 classes. All ideas for a potential new class location will be considered.

The Facebook feed is growing. It now has 423 members.

### NEW BUSINESS

Brett suggested we look into the Amazon Smile program that donates one-half percent of the price of purchases made through Amazon to nonprofit organizations. After discussion, Brett moved to register the club at Amazon Smile, second by Jayne. Sharon will attempt to set up the account for LGMC. Brett will write an article for the March Pick & Shovel explaining how the program works, and how to link orders to LGMC for the donations.



### COMMITTEE REPORT

The Summer Swap proposed to be held at the Beer Family Farm in Ashland is moving forward. Jayne is finalizing the purchase of liability insurance for the landowner; the club will pay the premium. Discussion of tables, tents, and booth rent. There have been four show and swap vendors express interest in having booths.

The information sheet will be finalized soon and sent to previous vendors. It will be posted on the Facebook page and the website; also published in the Pick & Shovel. Posting to other online calendars and publications will be handled by Publicity Chair, Jim Marburger.

Jim moved to adjourn the meeting, Vera 2nd. Meeting adjourned at 7:45 p.m.

## Silversmithing classes

### 2021 Schedule

#### Tuesday Evenings

7:00 p.m. - 10:00 p.m.

**The Jewelry Connection Ltd.  
Indian Village Shopping Ctr.  
13th & Arapahoe, Lincoln**

**Tuition: \$150 plus \$30 supply deposit**

**~~Session 1: Jan 5 - Feb 23~~**

**Session 2: Mar 2 - Apr 20**

**Session 3: Apr 27 - Jun 15**

**Session 4: Aug 17 - Sep 5**

**Session 5: Oct 12 - Nov 30**

Contact: Jayne Beer 402-890-3307  
Judith Bay 402-423-7058  
jbeer60070@aol.com

**JUNIORS**

by Brett Jurgens, Junior Co-Leader

I hope you all made it though winter and are looking forward to the upcoming nice weather. I am more than ready for warm sun and to be able to be outside more, especially if I'm outside looking for rocks! Our specimen boxes are ready; please reach out to me at quartz89@aol.com so that we can figure out a time to drop them off.



I am looking forward to when we are able to meet again and begin our lessons in our Future Rockhounds program. We will use the specimen kits with our lessons, and there will be more specimens to add to them.

The club is having a swap on June 26 and 27 at the Beer Family Farm near Ashland. Ideally, I would like to have a junior table and have some activities available, such as the Gem Dig. This is a fun activity and always a hit with the public. Also, it is one of the ways we are able to fund junior activities. Whether we are able to have a table is dependent on volunteers. There is space available both in the open air barn and outside. Let me know if you would be more comfortable with one or the other, and if you would be available to help. We would need a junior, along with a parent or guardian, to help out in the different time slots.

The swap should be a great time, lots of rocks to look at and an opportunity to safely meet up. We are also planning a meal Saturday night at the swap. More information is available in the Pick and Shovel and the Facebook page.

Be compassionate and stay safe.

Hey Juniors! Don't forget to enter the 2021 National Youth Poster Contest. The information was published in the January and February Pick & Shovel. Give your entries to Brett and Corey, and they will see that all entries for LGMC are sent together in one package.

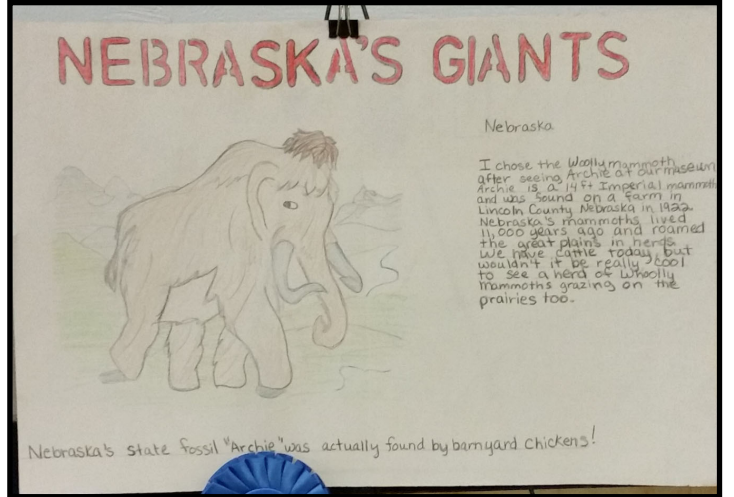

2015 Winners

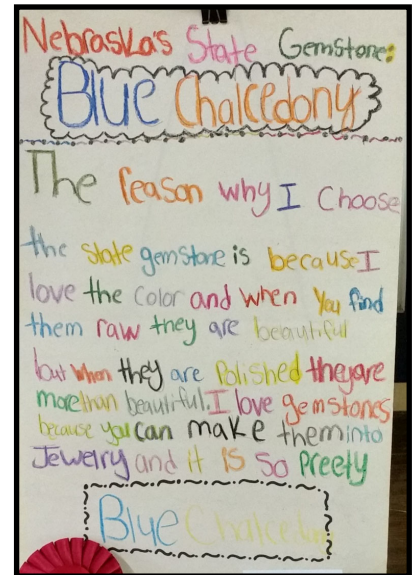
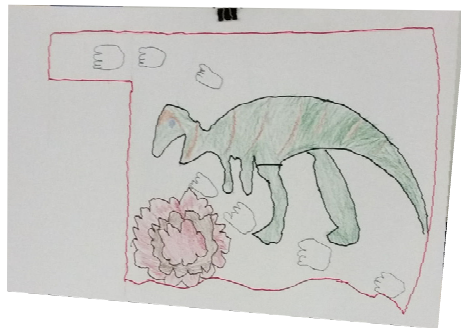

**J J & L Rocks & Minerals**

P.O. Box 68  
Hickman, NE 68372

**Lee Harrison**  
**Eric Harrison**  
**402.792.2337**

330 Locust  
Hickman, NE 68372

**James Marburger**  
**Sharon Marburger**  
**402.430.6703**

jimandjohn@jjlrocksandminerals.com  
www.jjlrocksandminerals.com  
jjlrocksmin - Ebay Username

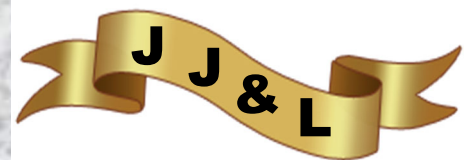

Proudly serving  
the hobby for  
45 years

LINCOLN GEM & MINERAL CLUB  
HOSTS A

# Summer Rock Swap

**June 26 & 27, 2021**

Saturday 9 a.m. - 6 p.m.

Sunday 10 a.m. to 4 p.m.



## Beer Family Farm

18701 Ashland Road, Ashland, Nebraska

**Admission: Adult \$2.00; Kids 15 and under \$1.00**

**Help the Lincoln Food Bank replenish its shelves.**

**Bring canned items for the Food Bank.**

Swap is open to the public, for both selling and buying.  
Everyone is welcome!

**Family  
Friendly**

**Jewelry**

**Fossils**

**Silent  
Auction**

**Buy  
Sell  
Trade**

**Lapidary  
Supplies  
&  
Equipment**

**Rocks  
&  
Minerals**

If you are interested in being a vendor, go to  
<https://www.lincolngemmineralclub.org/happenings/other-events>  
for more information and to fill out the Advanced Reservation form  
or let Corey or Sharon know at the contact info shown below.

LINCOLN GEM & MINERAL CLUB  
Box 5342

Lincoln, NE 68505-0342

Contact Corey Beer at 402.890.9155 or

Sharon Marburger at 402.429.3323; [lgmc.editor@outlook.com](mailto:lgmc.editor@outlook.com).

**2021 SUMMER SWAP**

LGMC is hosting its first public summer swap on June 26 & 27 at the Beer Family Farm near Ashland, Nebraska. Provided COVID doesn't alter the plans, here is what we know so far:

- Vendors will include dealers and swappers.
- Anyone wishing to swap or sell geology or hobby-related items are welcome to rent booth space.
- As with our usual Mid-Winter Swap, members of the public are welcome.
- Twelve booths of various sizes and rental rates are available inside a rustic barn; electricity available. These booths will be assigned on a first-come, first-served basis. Advanced reservations are encouraged. Rentals range from \$40 to \$160.
- Nearly unlimited spaces available outside, rented at \$25 per 10'x10' increments. Tables are available at \$10 per 8-foot table, advanced reservations only.
- Reservations are preferred, however, booth spaces will be available to those not having advanced reservations. Without an advanced reservation, barn spaces and table availability are not guaranteed.
- Outside vendors to provide their own awnings or pop-ups.
- Friday setup noon to 8 p.m.; Saturday setup 7 a.m.
- Saturday hours 9 a.m. to 6 p.m. Sunday hours 10 a.m. to 4 p.m.
- Silent Auction both days.
- Grill-out supper at 6 p.m. Saturday. Voluntary donations for meal will be accepted.

**Let Jayne and Corey know if you can help out with any aspect of the Swap. Let's make this a mammoth event!**

**ADVANCED RESERVATION**

**Reservation and payment due no later than April 1, 2021.**

- Outside Space (\$25 per each 10'x10' unit), \_\_\_\_\_ Number of units, \_\_\_\_\_ Number of tables needed at \$10 per each 8-ft. table
- Inside Space (See attached floor plan for booth rates), Booth choices (1<sup>st</sup>) # \_\_\_ (2<sup>nd</sup>) # \_\_\_ (3<sup>rd</sup>) # \_\_\_  
Spaces assigned on a first-come, first-served basis.

Name: \_\_\_\_\_ Business Name: \_\_\_\_\_

Address: \_\_\_\_\_ Phone No.: \_\_\_\_\_

Email: \_\_\_\_\_ Amount Enclosed: \_\_\_\_\_

Type of Product to be Sold: \_\_\_\_\_

Send your check with a copy of this Advanced Reservation form to LGMC, P.O. Box 5342, Lincoln, NE 68505  
OR

Submit electronically on the LGMC website, [www.lincolngemmineralclub.org](http://www.lincolngemmineralclub.org). Payment made through PayPal (link on website).

**Questions:**

**Contact Corey Beer at 402.890.9155 or Sharon Marburger at 402.429.3323.**

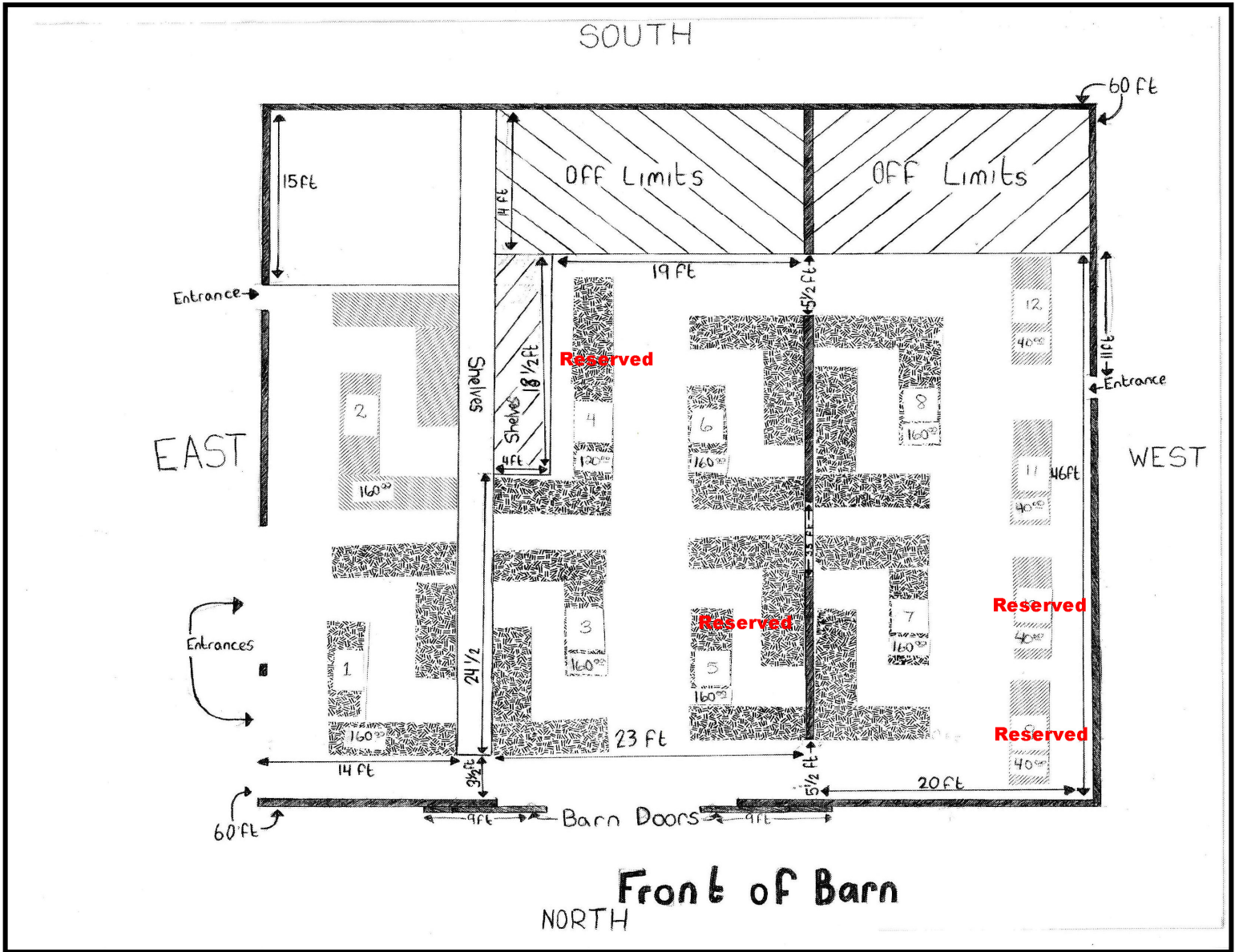

**Vendors and Volunteers are needed for the Swap, in order to make it successful. Club Booth, Junior Booth, Roaming Volunteers. Contact Corey Beer with your offers to help.**

2021 NATIONAL SHOW, JUNE 16 - 22

## 2021 AFMS & RMFMS Conventions

### Sublette County Rock Hounds' Gem & Mineral Show

SCHEDULE

June 16, 2021 WEDNESDAY	9am	Field Trip North of Farson, off old Hwy 191	Fairgrounds' Event Center, Door A
	TBD	Judges' Training	Fairgrounds' Commun. Hall
June 17, 2021 THURSDAY	9am – 5pm	Exhibit Set-up	Fairgrounds' Event Center
	9am – 5pm	Vendor Set-up	Fairgrounds' Event Center
	9am – 5pm	Delegate Registration, AFMS & RMFMS	Fairgrounds' Event Center
	9am – 10:15am	Uniform Rules Meeting	Fairgrounds' Commun. Hall
	10:30am – 12pm	AFMS Annual Meeting	Fairgrounds' Commun. Hall
	1pm	Scholarship Meeting	Fairgrounds' Commun. Hall
	3pm	Judge's Meeting	Fairgrounds' Commun. Hall
	5pm	Potluck	Fairgrounds' Canopy Area
June 18, 2021 FRIDAY	9am – 10am	Delegate Registration	Fairgrounds' Event Center
	9am	Show Opens	Fairgrounds' Event Center
	10am	RMFMS Executive Meeting	Fairgrounds' Commun. Hall
	5pm	Show Closes	Fairgrounds' Event Center
	5pm – 7pm	Social Hour, hosted by AFMS Pres. Judy Beck	Fairgrounds' Commun. Hall
June 19, 2021 SATURDAY	9am	Show Opens	Fairgrounds' Event Center
	10am	RMFMS Delegates Meeting	Fairgrounds' Commun. Hall
	12pm	President's Luncheon	Fairgrounds' Commer. Bldg.
	5pm	Show Closes	Fairgrounds' Event Center
	5pm – 6pm	Happy Hour	Fairgrounds' Commer. Bldg
6pm	Awards Banquet	Fairgrounds' Commer. Bldg	
June 20, 2021 SUNDAY	8am	Editor/Webmaster Breakfast	Fairgrounds' Commer. Bldg
	9am	Show Opens	Fairgrounds' Event Center
	11am	ALAA Presentation	Fairgrounds' Commer. Bldg
	1pm	ALAA Annual Meeting	Fairgrounds' Commun. Hall
	2pm	ALAA Live Auction	Fairgrounds' Event Center
	4pm	Show Closes	Fairgrounds' Event Center
	4pm	Exhibits Release	Fairgrounds' Event Center
June 21, 2021 MONDAY		Blue Forest Petrified Wood	led by Doug True contact <a href="mailto:dtruefossils12@yahoo.com">dtruefossils12@yahoo.com</a>
June 22, 2021 TUESDAY		Fish Fossil fee dig	led by Doug True contact <a href="mailto:dtruefossils12@yahoo.com">dtruefossils12@yahoo.com</a>

Daily during the Show there will be lectures; a schedule of events will be available near the Show entrance.

**2020 BOARD OF DIRECTORS****President**

Charles Wooldridge, 402.975.0416, charles.wooldridgeii@gmail.com

**1<sup>st</sup> Vice-President**

Jayne Beer, 402.890.3307, JBeer60070@aol.com

**2<sup>nd</sup> Vice-President**

Brett Jurgens, 402.850.3256, quartz89@aol.com

**Treasurer**

Vera Lyman, 402.464.6089

**Secretary**

James Marburger, 402.430.6703, james.marburger@outlook.com

**Board Member**

Corey Beer, 402.466.6628

**Board Member**

Jeff Kubitz, 402.540.9395, jkubitz@neb.rr.com

**Board Member**

Sharon Marburger, 402.429.3323, lgmc.editor@outlook.com

**Board Member**

Ed Ridge, 402.805.8248

**LONG RANGE PLANNING & BY-LAWS COMMITTEE**

Jayne Beer, Chairman

- 1 year: Pat Dvorak  
Robert Gruit
- 2 years: Charles Wooldridge  
Sharon Marburger
- 3 years: Vera Lyman  
Jim Marburger

**NOMINATING COMMITTEE**

Jayne Beer, Chairman

- 1 year: Linda Guenter  
Vera Lyman
- 2 years: Brett Jurgens  
Sharon Marburger
- 3 years: Jim Atkins  
Open

**ADVERTISING INFORMATION**

Advertising by rock / hobby business or interest is permitted with the approval of the Board of Directors. Contact the Editor with your proposed ad. The rate is set at \$20.00 per full page; \$10.00 per 1/2 page; \$5.00 per 1/4 page (minimum) per issue, paid in advance to the Club treasurer. Ads will be placed throughout the newsletter as space permits.

**STANDING COMMITTEES****Audio/Visual:**

Jayne Beer

**Audit:**

Ed Dvorak, Jayne Beer  
James Marburger

**Christmas Party:**

Edward Ridge

**Door Prizes:**

Corey Beer, Brett Jurgens, Charles Wooldridge

**Facebook:**

James Marburger, Jayne Beer

**Field Trips:**

James Marburger

**Historian:**

Sharon Marburger

**Legislative Liaison:**

Susy McMahan

**Membership Record:**

Edward Ridge

**MWF Liaison:**

Vera Lyman

**Programs:**

Charles Wooldridge, Brett Jurgens

**Property:**

James Marburger

**Recognition/Awards:**

Ed Dvorak, Jayne Beer, Charles Wooldridge

**Refreshments:**

Vera Lyman

**Show—2021:****Swap—2021:**

Brett Jurgens

**Website:**

Jim & Sharon Marburger

**Youth Activities:**

Brett Jurgens, Corey Beer, Sampson Bayer

**MEMBERSHIP INFORMATION**

Membership dues for the Lincoln Gem & Mineral Club are as follows:

- Adults (age 16 and over) - \$20 per year or \$30 per couple (within the same household)

- Juniors - \$3 per year (with a responsible adult)

All new memberships must be accompanied by a written application. Prospective members must gain Board approval and attend one regular meeting before paying dues. Applications are available on the website: <https://www.lincolngemmineralclub.org/about/membership>,

or you may contact Treasurer Vera Lyman for a printed copy.

Mail Exchange Newsletters to:  
Lincoln Gem & Mineral Club, Inc.  
P.O. Box 5342  
Lincoln, NE 68505-0342



Or e-mail newsletters to:  
lgmc.editor@outlook.com

A color version of the Pick & Shovel is available at:

<http://www.lincolngemmineralclub.org/index.php/newsletters/current>

# PICK & SHOVEL

## PICK & SHOVEL STAFF

### **PUBLISHER:**

Lincoln Gem & Mineral Club, Inc.  
P.O. Box 5342  
Lincoln, Nebraska 68505-0342

### **EDITOR:**

Sharon Marburger  
E-mail: lgmc.editor@outlook.com

### **CIRCULATION:**

Vera Lyman  
402-464-6089  
Sharon Marburger  
402.429.3323

### **DEADLINE:**

Date of Board Meeting, usually the 1st  
Thursday of the month.

Please send your hobby-related photos with captions or explanations for publication in the Pick & Shovel. Field trips, lapidary projects, fossil projects, metal projects, wire wrapping, tumbling, or any other activity of interest to the club. Since we are not allowed to meet in person at this time, it is important to share with others what you are doing. Your project may inspire someone else. Send via email (lgmc.editor@outlook.com) or via Facebook Messenger.