

CALENDAR

May 21 - Regular Meeting -A dessert supper at Bethany Park Shelter, Cotner and Vine Sts. Coffee furnished. Bring your favorite dessert or snack and your own table service. Charles has arranged to have Mr. Marve Anderson present a program on 'Topaz Mountain Mine' and will arrange a 'Topaz' dig that nite.

Study Group- Completed this series at April meeting. See page 5

Field Trip- Planning to go to Nebr. State Swap at Grand Island May 14 or 15 as a group trip- we'll be calling!

June 25 - A Picnic at Wooly's acreage-Rural Denton at 4 P.M. Map and details on page 4B in this bulletin.

August 29 Board of Directors Meeting for Sept. will be at the motorcycle shop, 73rd and north Cotner Blvd., 7 PM

Welcome these new members, add their names to your '94 Who's Who
Ron & Barbara Toma and their daughter Linda Toma
4901 South 56th Street, #7, 68516, Phone 423-7041

Next LGMC SHOW-March 25 and 26, 1995, Pershing Auditorium.

NEBRASKA ASSOCIATION OF EARTH SCIENCE SHOWS 1994

May 14-15	STATE SWAP	Grand Island Earth Science Society. Izaak Walton Park, G.I. NE.
May 21-22	SHOW	Northeast Nebr. Rock & Mineral. Society. Norfolk, NE
Sept. 10-11	SWAP	Fort Kearney Rock Club Cottonmill Park, Kearney, NE
Oct. 1-2	STATE SHOW	Nebraska Gem & Mineral Club Omaha, NE
Oct. 15-16	SHOW	G.I. Earth Science Society Fonner Park, Grand Island, NE
Nov. 5-6	SHOW	Fort Kearney Rock Club Hill Top Mall, Kearney, NE

1994 REGIONAL SHOW SCHEDULE

ROCKY MOUNTAIN FEDERATION

July 22-24
Rushmore Plaza Civic Center, Rapid City, SD
Host: Western Dakota Gem & Mineral Society
Show Chair: Tom Estes, HC 33, Box 8713,
Rapid City, SD 57701 (605)342-2147

MIDWEST FEDERATION

September 2-3
Century Center, South Bend, IN
Host: Michiana Gem & Mineral Society
Show Chair: Margaret Heinek, 7091 E. East Park La.
New Carlisle, IN 46552 (219)654-3673

SOUTH CENTRAL FEDERATION / AFMS COMBINED

June 23-26
Astro Arena (next to Astrodome), Houston, TX
Host: Houston Gem & Mineral Society
Show Chair: Ron Carmen, 6947 Foxhurst,
Humble, TX 77338 (713)446-8949

EASTERN FEDERATION

July 8-10
Syracuse, NY
Host: Gem & Mineral Society of Syracuse, NY
Show Chair: Lewis Buddell, 2718 Falls Rd,
Marcellus, NY 13108 (315)673-1891

CALIFORNIA FEDERATION

San Diego County Fairgrounds, Del Mar, CA
Host: El Cajon Valley Gem & Mineral Society
Show Chair: Bob Bergman, 410 S. First, #198
El Cajon, CA 92019 (801)442-6211

NORTHWEST FEDERATION

June 3-5
Union Station, Ogden, UT
Host: Golden Spike Gem & Mineral Society
Show chair: Evan Day, 509 Highland Blvd,
Brigham City, UT 84302 (801)723-3830

CLUB NOTES

LGMC BOOK REPORT Ben Darling

This past winter I had the chance to read several of the books from the club library. Mineralogy for Amateurs (1964), Gemstone of North America (1959), Guidebook for Field Conference D International Assoc. for Quaternary Research (1965), and Geology of Franklin, Webster, and Nuckolls Counties, NE USGS bulletin 1165, with maps (1964).

Mineralogy for Amateurs and Gemstones of North America by John Sinkankas helped fill in some of many of the blanks in my knowledge of gems and minerals. Mineralogy treated the physical properties of the stones we value, and went into crystallography to a depth that should help anyone wanting to facet, or better identify crystal samples they may find. Gemstones of North America, while not claiming to be comprehensive and having a slight bias toward faceting materials, can serve as a vacation planning guide if you know little about gems and minerals in an area you may be going to. It does this by listing the states where various materials have been found, sometimes to the scale of particular mines.

Closer to home, Guidebook D drifts into South Dakota and Kansas, and visits several interesting sites, as does the Survey Bulletin. While dry in style they offer information about the past of the Great Plains, and about the other third of our scenery here, the land and landforms. These titles provide the opportunity to get the most for your travel dollars by suggesting other things to look for and at as you travel the state, and some things worth visiting for their own sake. I plan to find more of these guides and surveys that deal with the Great Plains, and will review them as I find them, even though the information may be more earth sciences than gem and mineralogy. Did I mention the USGS Bulletin had an opal location south of the Republican in Nebraska?

Thanks Ben for adding interest to our Pick & Shovel. Hope some of you will review our new materials and share your views with us. ED

OPEN HOUSE! Sunday afternoon, May 15, 1994, in honor of Life Member, Helena Baegl and her sister Emma. This will be from 2 to 3:30 P.M. in the dining room at Orchard Park, 3110 South 48th Street, Lincoln. It is being planned by their friend Mrs. Lola Jansing.

We've just purchased a group of very slightly used books to add to your reading pleasure. We plan to have them and the other newly purchased books and videos at the May Meeting for your inspection and if all goes well they will be available to check out for the summer if you find one that interests you.

THE PRESIDENT'S MESSAGE

Fellow Club Members

Family Rockhounding is a popular recreational activity which shouldn't be taken for granted. (Granite?) Whether hunting for fossils, gems, or minerals, families that Rockhound together may experience better mental health and improved communication. Mutual activities foster better relationships within families.

All leisure activities contain elements which may be more or less beneficial to the participants - watching television for example, contributes little to family communication or interaction. Essentially, it's a passive, individual activity that can have negative results. A parent taking their son or daughter to a ball game usually is more positive. In this case family members communicate and interact more although, as spectators their level of activity is limited.

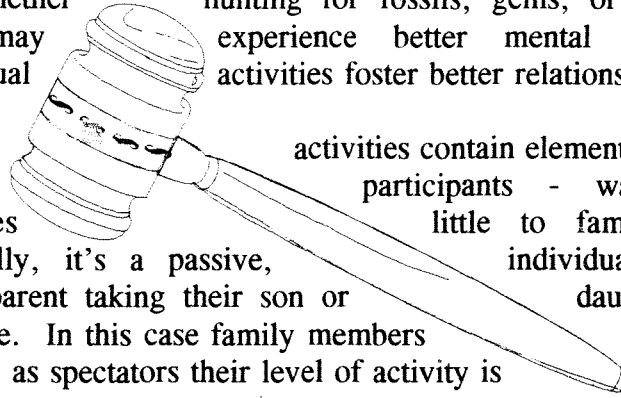

Rockhounding presents a surprising number of positive factors that make it one of the best shared activities. Field collection offers a chance for family members to have a positive influence on each other, yet provides opportunities to be alone without being lonely. Selecting an area to search away from the rest of the family can provide a sense of separateness, while being aware of others close by.

The level of competition inherent in many leisure activities can be concerning. In Rockhounding there is usually an atmosphere of healthy family competition for size, quality and quantity of specimens found. When competition focuses on doing the best you can, rather than on beating someone else, valuable lessons are learned.

People look for rocks for a wide variety of reasons, but one must certainly be the increased cooperation and communication that can develop while in the field. When Rockhounding, even strangers tend to share information about locations where specimens can be found, and techniques to use in extricating them, etc.

Children find ample opportunities to discover and practice independence as they learn to choose their own favorite rocks to search for, where to look for them, accept or reject advice, and take responsibility for their own equipment and collections.

Many people find Rockhounding very relaxing. This can be attributed to the fact that Rockhounding takes place away from the fast pace of the modern city. Being in the out of doors in the arms of nature provides a unique setting for tranquility and reflection.

The next time you wonder how you can spend quality time with your family I encourage you to consider a family field trip. Enjoy the summer!

Woody

Finding New Collecting Areas Part 9 -- Using Maps

Edward P. Pedersen

Easy to get and use sources of information that can lead to new collecting finds are maps. The U. S. Geological Survey (USGS) publishes topographic maps that cover much of the United States. To get a list of the available maps and a free booklet titled Topographic Maps, write the Map Distribution Section U. S. Geological Survey, Federal Building, Denver, Colorado 80202. A visit to the local Boy Scout Office or supply store will produce several Merit Badge instruction books on map reading, surveying, and other useful information.

A topographic map (topo for short) uses contour lines to show, on a flat map, the land form features seen (such as hills and valleys, mountains, canyons, flat areas, and so forth). These contour lines are shown in brown on the USGS maps. All places along each individual contour line have the same elevation above sea level. Water areas, such as lakes, coastlines, rivers, etc., stand out because they are in blue. Solid green areas represent forests or other vegetation covered areas. Roads, trails, towns, and buildings are generally in black, red or gray.

A few of the large scale maps (1":250,000') will cover an entire state and show all the major land forms (mountains, valleys, canyons, etc.) and the location of most roads, trails, and major mines. Such a map could be used to determine where agate, jade or other gem stones might be found if they are known to be weathering out of the rocks at a particular area (these materials will be deposited along the modern or ancient stream beds).

If you find this material in a stream bed, a topographic map may save hours or days by indicating the possible direction of source and the easiest way to reach the upstream areas. For example, it would be more valuable to search where the major tributaries join the stream of interest than to check an upstream part of each tributary. By checking at the stream junction, you may be able to eliminate one or more of the branches. If the material is found only in a few places it may be important to mark the finds each on your topographic map. Assuming that each sample has moved downhill or downstream, unless it was carried by man, a map showing the occurrences should narrow down the area to be searched.

As the area of search is narrowed down, it is worth changing to a more detailed map (15 or 7-1/2 minute Quadrangle topographic maps.) These maps show a great amount of detail and will show the collector the locations of buildings, mines, prospect pits, quarries, roads and railroads, and gravel pits which may be the key to finding a new area.

Mines, prospect pits and quarries are obviously good places to look. Old gravel pits often provide good collecting for lapidary materials and large fossils, which were dumped by the pit operators in the "over-size pile". Most buildings indicated on the maps will not be clues to a collecting find, however old mine offices and mills may indicate areas in which there are unmarked mines and prospect pits. This is especially true if the area is mountainous and has a lot of short roads or trails on the hillsides. Roads and railroads provide good rock exposures in cuts along their road beds. Depending on the geology of the area any type of gem, mineral, or fossil material could be found in such cuts. The writer has collected minerals and fossils from road and railroad cuts. Occasionally worthwhile specimens will be found in the rock used to build dams and prevent erosion around bridges.

Some of the mines shown on the topographic maps will be named, however, most will not. Sometimes the only designation will be the symbol for a mine or quarry, perhaps accompanied by the name of the material mined (such as zinc or limestone). This information and the location as shown on the map may be used for further research. Before such research is started other available maps, if any, should be checked to see if they give information. Sometimes the area has been recently remapped and an older map of the area may have more of the old mines marked. Usually these older maps are out-of-print and a call to a local university (Geology or Geography Dept.) or a public library may be necessary to locate a copy. Once a copy is found, you can arrange a visit to examine it. These sources may have maps of the entire state which can be used instead of purchasing the maps before selecting a specific area of interest.

Many people are not aware that the counties usually publish road maps which may show mines, streams, and quarries, as well as the roads and towns. These maps are either free or low priced and can be obtained by writing. The writer has found that, in parts of Arizona, the county maps contained information that was not shown on other maps. These maps may show mine roads and give mine names. Much collecting and prospecting is done in National forests. A letter to the Superintendent of the National Forest can produce a map showing the forest boundaries and the roads and trails within the forest. The outlines of patented mining claims and other properties within the forest may be shown.

LINCOLN GEM & MINERAL CLUB, INC. - GENERAL MEETING - April 23, 1994 7:30 P.M.
NCCE - Columbus Rm.

Meeting called to order by the President. Minutes were approved with a motion by Gerald Moore, 2nd by Susan Taylor. Carried.
Treasurer's report was approved with a motion by Dave Heffelbower, 2nd by Ralph Ulrich. Carried. (Both approvals were as printed.)
Hospitality reported 19 members and 8 guests present.

No old Business.

NEW BUSINESS: President announced the purchase of the 16 books from Dr. LeWorthy and "Cellars Of Time" from NE Game/Parks for the Club Library.

Announcements: May Meeting will be at Bethany Park with Dessert Picnic!
Treasurer Phyllis P. reported that an estimated \$ 3,211. profit from Show was realized.
A round of applause was given for the 1994 Show Chairperson, Billy H. THANKS, BH!
Ralph Ulrich reported that the Study groups were a success and is looking forward to some new groups & facilitators.
Grant Quinn had knee surgery. Is home and hopes to teach his Class in May.

SCHOLARSHIPS: Recipients were introduced and received their rewards.
Rod Vasek and Zoran Kilibardo each received our annual Scholarship awards.
Jon Mason was the recipient of a one-time Grant in the name of J.D. & Myrtle Young.
Each recipient gave an excellent presentation of his studies. The evening was closed with Fellowship, as cake & coffee were served.

Respectfully submitted,

Vera Lyman
Vera Lyman, Secretary

LINCOLN GEM & MINERAL CLUB, INC. BOARD OF DIRECTORS April 4, 1994
7:00 P.M. at Cycle Shop

Meeting called to order by President Wooldridge.
Minutes of the previous Meeting and Treasurer's report were approved as read.

BILLS: Club bills and Show bills were presented and approved with a motion by Shirley Rockel & 2nd by Kevin Schwartman. Motion carried.
Bill for \$ 216. to Pershing for Friday refreshments was paid as a Club Bill.
It was suggested that this be referred to the 95 Show Committee as a Show expense in the future.
Motion at Feb. Meeting to purchase \$ 2000. CD 4 18 Mo be amended to 24 mo. Amended motion by Vera L. 2nd by Phyllis P. Carried.

SHOW NEWS: Show Gate receipts discussed. Not enough Show bills in to predict "gain/loss" status of Show at this time.
Thank You's to Hy-Vee, Econo Foods, Caterers, Latvians & numerous others for participating in making our Show a success.

NEW BUSINESS: (Library) Dr. G. Wm. LeWorthy presented a list of Silversmithing books he desired to sell. Motion was made by Shirley R. that we purchase the 16 books for \$ 50. 2nd by Billy H. Carried.
Motion by Vera L. that we purchase 1 copy from NE Game & Parks "Cellars Of Time" for Club Library. 2nd by Phyllis P. Carried.

(Membership) Re-instated members (as listed in P & S) were approved with motion by Phyllis P. 2nd by Shirley R. Carried.

(Programs) April - Short presentations by each Scholarship Recipient.
May - Marv Anderson "Topaz Mountain Mine" Also have Topaz concentrate for members to "hunt" through!!

MAY MEETING: 5-21 at Bethany Park with "Dessert Picnic. Bring your own plates & service.

Discussion of making list of duties for Show Chairperson, and separate Committee Chairs.
Meeting adjourned.

Respectfully submitted,

Vera Lyman
Vera Lyman, Secretary

LINCOLN GEM AND MINERAL CLUB April 1994 TREASURER'S REPORT
NBC Checking Balance 04/01/94 44071.09

Receipts:
Donation sent through Adeline 5.00

Payments:
Member subs to NADESCI 102.00
Misc. Expense Treas. & P. & S. 6.57
Set-up refreshments Friday show 215.06
April Pick & Shovel 13.09
Curtesy/Membership 6.70
May Meeting Rent 35.00
Collection used Gem Books 50.00
Grant Geo. Student/Mem. JD & Myrtle 200.00
Partial box labels P & S & Show 80.00
Balance 1994 Show Expenses 3148.46 3856.88

NBC Checking Balance 04/30/94 5 2219.21

Notice - A summer activity- Put June 25, Saturday, around 4 P.M. on your calendar. Wooly is inviting us to have a get together at his acreage near Denton. Map below. Club will furnish cups & drinks, hotdogs and buns. You each bring a covered dish - salad, casserole, dessert or ? and your own table service, chair or blanket or perhaps a card table or tray. Wooly promises a pond to fish in, lots of fresh air (hopefully no rain) and we plan to do 'Rock Bingo' with prizes. Sez he has a few poles for the young people to try their luck. Come one! Come all! Lets Socialize.

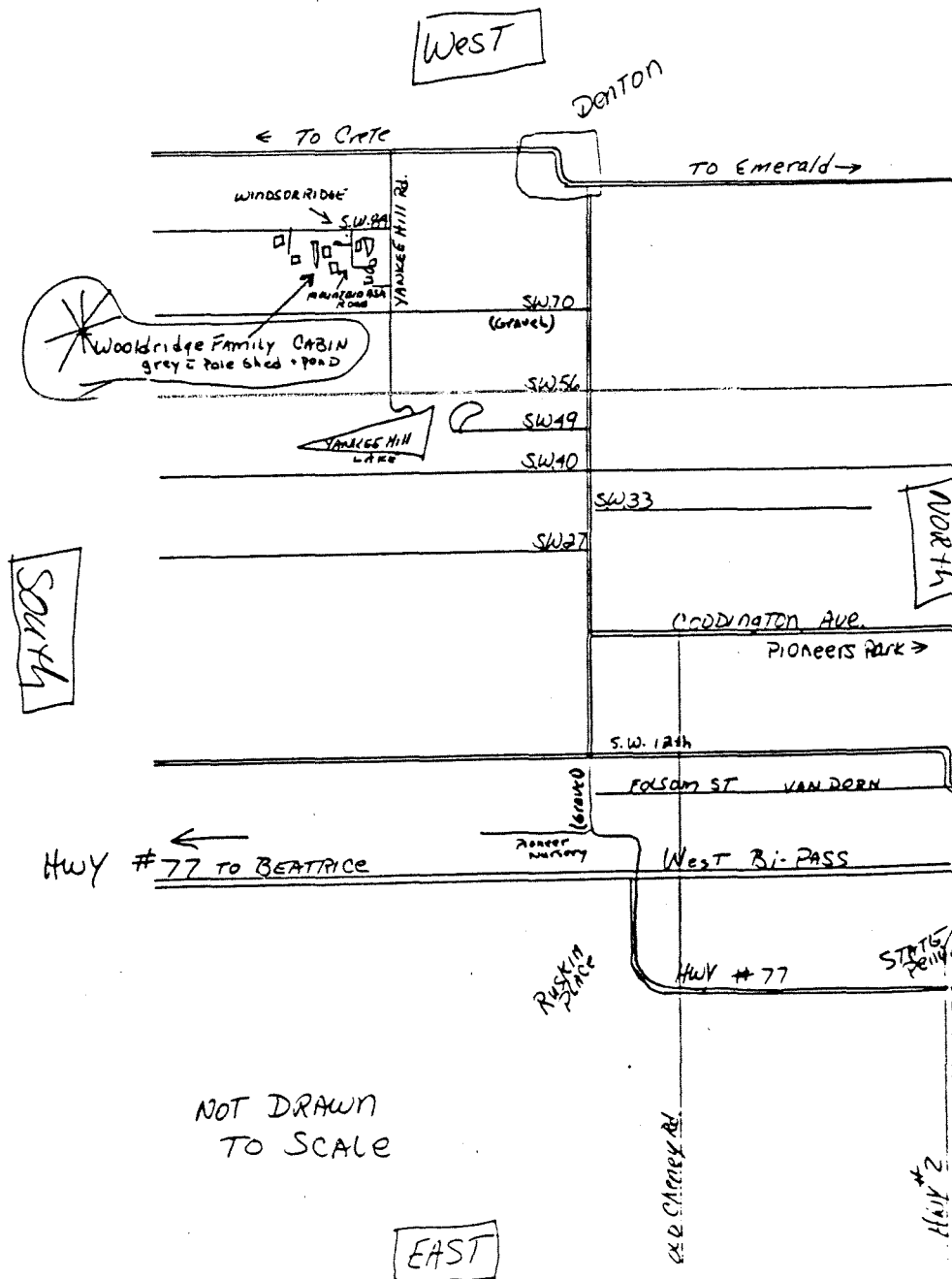

A PLEASING AND UNEXPECTED REWARD

The president assured me that the job of coordinating would be simple, just find a place for meetings. I only agreed to do it because there seemed to be a need for such an activity.

Our good friend, Roger Pabian agreed to lead the group in the study of free-form lapidary. We set the regular meeting times and formed very basic ground rules. So I had a group to coordinate.

Most of the time at the first meeting was used to cover the general scope of our study. We wanted to strive for creativity and interpretation. We defined the meaning of freeform and introduced the descriptive words we would be using, such as spatial, temporal and iconography. Within the group we talked about techniques but only as an end result of the cutting and polishing.

During the third meeting, we discussed the various freeform shapes and their merits or drawbacks. Roger offered the idea that iconography, since it deals with cultures and in a way their pictures and symbols, would add to our choices of subjects for lapidary art. He assigned each couple an ethnic group to study. Rosa Lee and I were chosen to study the Celtic people and their iconography. What I learned during the following weeks was really an unexpected reward. These people developed a very unique art form.

Ed ridge and Ben Darling also found new shapes from their study of the people from India and from Australia Outback. You may have seen examples of their work at the show. Also, Roger displayed some of his examples of freeform lapidary. We thank you for sharing with the general public.

Thank you Roger, for sharing your teaching expertise with us. Also I thank those of you that took time to attend the meetings for your support.

We really appreciate the inspiration and guidance that Bill and Betty White have so generously given toward our effort.

Those of you who missed that session may wish to watch for the next study group. We are looking for a show of interest in some specific category, such as fossils, minerals, or another lapidary group. Please talk to Kevin Schwartman or me so we can direct our efforts toward another study group.

Study group coordinator, R.L. Ulrich

ROCK OF THE MONTH- Bring an agate, any shape, size or type - but one that you have a special feeling for. A case will be provided.

MIDWEST FEDERATION OF MINERALOGICAL AND GEOLOGICAL SOCIETIES

Member of the American Federation of Mineralogical Societies

OFFICERS 1993-1994

PRESIDENT
Mr. Marvin Starbuck
7636 V Avenue East
Vicksburg, MI 49097
616-446-1991

FIRST VICE-PRESIDENT
Mrs. Anne Cook
484 Odellman Road
Cleveland Heights, OH 44121
216-361-9033

SECOND VICE-PRESIDENT
Mrs. Mary Hanson
Route 1 - Box 63
Hazenville, IL 62344
217-467-2285

SECRETARY
Miss Jean Reynolds
107 Tuttle Avenue
Cleveland Hills, IL 60814
708-323-1482

TREASURER
Mr. Norman Hanson
6407 Starbuck Lane
Canton, MI 48107
313-455-8996



NEWSLETTER

Published monthly
except July/August

MAY, 1994 - Issue No. 332

Kitty Starbuck
7636 V Avenue E
Vicksburg, MI

PRESIDENT'S MESSAGE

Good Morning,

Kitty and I just got home from what we felt was a "good" meeting in Columbus, Ohio. Here are some of the high lights:

Kathy Miller and I will be attending the AFMS/MWF Show and Convention in Houston June 23-26. We have been instructed by the Executive Committee to vote "NO" on the 25¢ dues increase for the AFMS.

Dean Stone had several handouts pertaining to the Alert! Alert! Alert!, the special mailing that was sent to all clubs regarding the new proposed regulations by the U.S. Forest Service. He had complete copies of the Federal Register for everyone present. There is a copy of the Alert! in this newsletter, in case yours was misplaced.

WE HAVE BEEN GIVEN A 30 DAY EXTENSION!!!

We now have until May 18th to respond. They have received several letters, most of them from rockhounds...rockhounds from the Midwest. When you write, let them know how you feel, and ALSO ASK QUESTIONS...

Why are you doing this?
Why can't we pick up a fossil?
Why can't we pick up a mineral?
Who is going to enforce these rules that cover millions of acres?

I'm sure you can think of others. If you write just a letter complaining, they do not have to answer. BUT, if you write a letter, and ask questions, by law, they have to answer your questions.

Or call Kathryn Toffenetti at 202-720-2651. It only costs 75¢ for 2-3 minutes.

You will also find a petition in this issue, make copies if needed, and collect as many signatures as you can...this affects everyone, hikers, bikers, snow-mobilers, fishermen, birdwatchers, vacationers, the list goes on and on.

In this issue, you will find a complete record of the status of the MWF Endowment Fund, the status of the participating clubs, and a financial report.

Next page please...

The Endowment Fund Committee will be in charge of both the Silent Auction and the Raffle at the Show and Convention in South Bend September 2-3-4. John Beall, Silent Auction chairman has a plea and a copy of the bid sheet in this issue. He is asking that you make copies of the bid sheet, and have it already filled out with the information about your donation when you bring it to the show.

The Raffle is under the auspices of Harold Rice...as with John, Harold is also looking for nice donations for the raffle. Let's make this a super Silent Auction and Raffle.

The 1994 Directories are available. Those that weren't picked up at the meeting will be mailed shortly. They are also available from Gordon Boone for \$3.00 plus shipping and handling.

CONGRATULATIONS! are in order for Diane Dare. Beginning with the May-June issue of ROCKS DIGEST (formerly Big Rock Trader), Diane will be writing book reviews. I certainly hope she's better at book reviews, than she is at being an "eddy-tor"

On page 7 of the December, 1993 issue of the MWF Newsletter, there was a "Notice" telling about "free" material for teachers, from MII. Kitty wrote and asked if they had anything available to handout to the teachers that bring their kids to our show. Last week, UPS delivered a large box containing 25 packets. Each packet has 4 posters, an activity book, and a source book. These are all free, all they ask is that you send them the names of the teachers, so they can send them information as new material becomes available. MII is a non-profit organization, and is a major source for teacher support materials, educational programs and information about minerals and natural resources. A packet was on display at the meeting, and several people asked for the address...

MINERAL INFORMATION INSTITUTE, INC.
475 17th STREET, SUITE 510
DENVER, COLORADO 80202

Send for it, and pass it along to teachers in your area. I'm sure they would appreciate it.



Sincerely,
Marvin Starbuck

FOR FUN MAKE YOUR "OWN" ROCK

Want to try your hand at carving? Make your own "rock"! It's easy even for the kids, and what's more, it will look exactly like rock, be almost white, and will have a granite-like texture.

INGREDIENTS: 1 part water, 1 part plaster of paris, and 1½ parts vermiculite (found at a building supply store). Mix in a plastic bucket. CAUTION!! DON'T pour any of the mixture down the sink. Pour mixture into a clean milk carton, and let set for 4-5 days. To harden quicker, reverse the process by using more plaster of paris. Clean bucket with paper towels.

Carving can be done with simple kitchen tools. Use your imagination and have fun. Remember, if you are carving an elephant, just take away everything that doesn't look like an elephant! After drying for about a week, your sculpture can be painted, or left in its natural state.

Via: Sooner Rockologist March-April 1976



1994 ELECTED OFFICERS

President:	Charles Wooldridge, 836 S. 31st St.	Lincoln NE 68510	475-9034
1st Vice President:	Pam Killion, 3425 'N' St.	Lincoln NE 68510	477-1780
2nd Vice President:	Jerry Moore, 2305 So. 35th St.	Lincoln NE 68506	489-4184
Secretary:	Vera Lyman, 420 N. 56th St.	Lincoln NE 68504	464-6089
Treasurer:	Phyllis Parks, 2435 So. 19th St.	Lincoln NE 68502	476-6798
Board Member:	Ed Ridge, 2507 A St.	Lincoln NE 68502	477-8469
Board Member:	Kevin Schwartzman, 5522 Shady Creek Ct.	Lincoln NE 68516	423-5523
Board Member:	Billie Heffelbower, 1819 Washington St.	Lincoln NE 68502	475-4713
Board Member:	Shirley Rockel, 1134 West Avon Lane.	Lincoln NE 68505	464-3059

Nominating Committee

3 Year:	Francis Belohlavy Ralph Ulrich
2 Year:	Jim Marburger Kathy Schwartzman
1 Year:	Jim Parks Janet Wright
Chairman:	Immediate Past President

Long Range Planning & By-Laws Committee

3 Year:	David Heffelbower Jim Parks
2 Year:	Vera Lyman Roger Pabian
1 Year:	Kevin Schwartzman Jim Marburger
Chairman:	Immediate Past President

Standing Committees

Membership:	Shirley Rockel	Programs:	Charles Wooldridge
Education:	Roger Pabian	MWF Luncheon:	Vera Lyman
Field Trips:	Kevin Schwartzman	Scholarship:	Dwight Miller
Historian:	John & Lillie Lewis	Christmas Party:	{ Billie Heffelbower Shirley Rockel
Hospitality:	Eddie "Lightning" Ridge	1994 Show:	Billie Heffelbower
Study Coordinator:	Ralph Ulrich/Kevin Schwartzman	1995 Show:	John Harrison
Housing/Property:	Jim Parks	1994 Swap:	Kevin & Kathy Schwartzman
Youth Activities:	Pam Killion	1995 Swap:	Dave Heffelbower
Librarian:	Jim Parks		
Auditing Committee:	Jerry Moore, Francis Belohlavy, Mike Jurgens		
Gem Palette Correspondent:	Pam Killion		
Geology Day Coordinator:	Jerry Moore		

Your PICK & SHOVEL Staff

Publisher:	Lincoln Gem & Mineral Club, Inc., P.O. Box 5342, Lincoln, NE 68505-0342
Editor:	Phyllis Parks 476-6798
Business Reporter:	Vera Lyman 464-6089
Circulation:	Jim Parks 476-6798

The *PICK & SHOVEL* is the official publication of the Lincoln Gem & Mineral Club, Lincoln, Nebraska. Articles and items appearing within may be reproduced in other club bulletins, provided proper credit is given to the *PICK & SHOVEL* and the author and that a reprint of the bulletin is sent to the editor of the *PICK & SHOVEL*.

The purpose of this corporation shall be to study, promote an interest in, and disseminate knowledge of lapidary and various Earth Sciences including but not necessarily limited to geology, paleontology and mineralogy. It shall be a particular purpose of the corporation to provide education in these fields to its members and the general public, particularly youth and student groups.



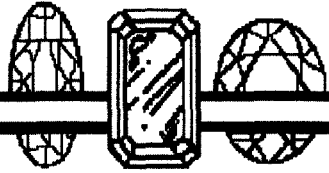

Wooly's Custom Lapidary

Precious/Semi-Precious Gems 836 S 31 St.

Rough Material Lincoln, NE 68510

Jewelry and Supplies 402-475-9034

By Appointment Only

J J & L

Rocks & Minerals

P.O. Box 68

330 Locust

Hickman, Nebraska 68372

Open by appointment 402-792-2337 or 792-2348

Read your bulletin for new materials or specials from the above advertisers.

Advertising by rock-hobby business or interest is permitted with the approval of the Board. The rate now set at \$15.00 per full page; \$7.50 per 1/2 page; \$5.00 per 1/3 page; and \$3.75 per 1/4 page(min) per issue, paid in advance. These ads will be placed through the bulletin as space permits.

Subscription to the *PICK & SHOVEL* are \$10.00 per year mailed.

Dues to Lincoln Gem & Mineral Club are as follows:

Adult	(ages 16 and over)	\$10.00/year
Junior	(ages 12 to 16)	\$2.00/year
Family Membership	(Husband, wife, resident children under age 16)	\$22.00/year

New memberships must be approved by the Board, after the applicant attends at least one meeting of the club and pays the above dues plus a \$5.00 registration fee.

THE PICK & SHOVEL

MAY 1994

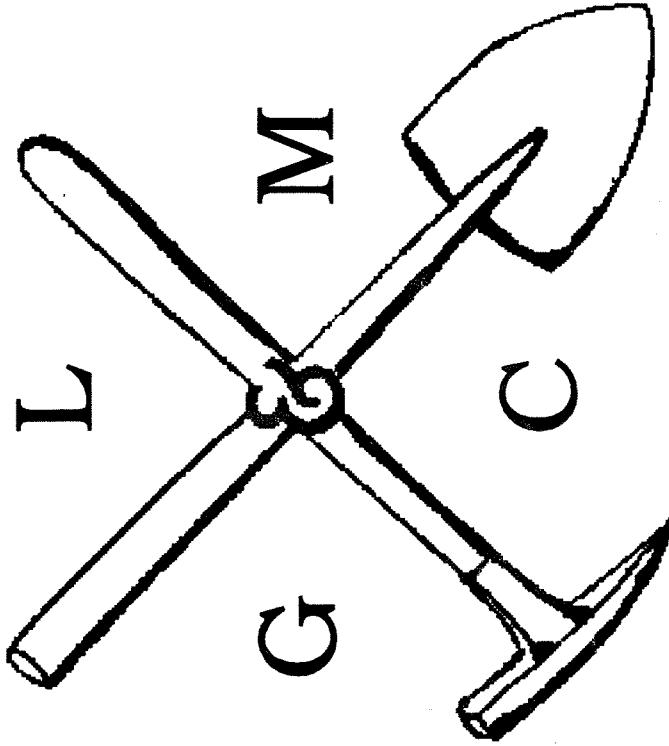

OFFICIAL PUBLICATION OF
LINCOLN GEM & MINERAL CLUB
LINCOLN, NEBRASKA

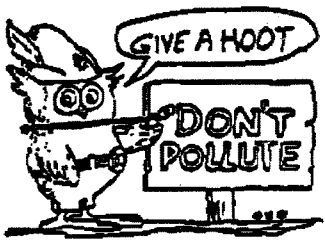

Mail Exchange Buletins To:

Lincoln Gem & Mineral Club
Box 5342
Lincoln, Nebraska 68505-0342

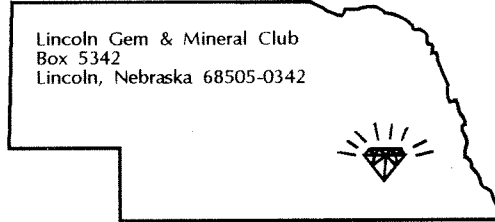

H. E. L. P.

Help Eliminate Litter Please

Associated with

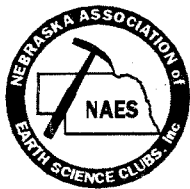

Edward Ridge
2507 A Street
Lincoln, NE 68502