

# THE PICK & SHOVEL

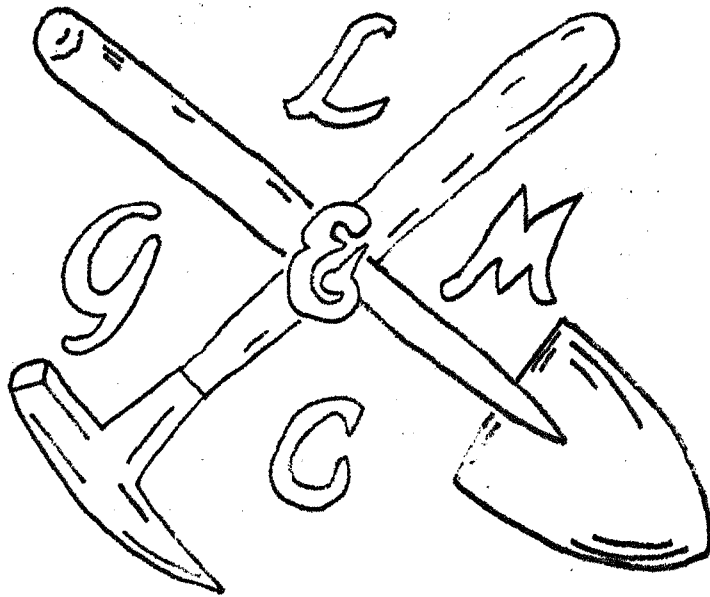

L I N C O L N   G E M   &   M I N E R A L   C L U B ,   I N C .

Lincoln, Nebraska

*April 1968*

Official Publication of  
THE LINCOLN GEM AND MINERAL CLUB, INC., LINCOLN, NEBRASKA

The purpose of the corporation shall be to study, promote an interest in, and disseminate knowledge of lapidary and various Earth Sciences, including but not necessarily limited to geology, paleontology and mineralogy. It shall be a particular purpose of the corporation to provide education in these various fields to its members and the general public, particularly youth and student groups.

---

1968 ELECTED OFFICERS

President - Mr. Howard Taylor, 910 New Hampshire, 68508	432-3707
1st Vice-Pres. - G. W. McKinney, 6720 Ballard, 68507	466-0196
2nd Vice-Pres. - Louise Baugher, 7415 Englewood Dr., 68510	488-4274
Recording Secretary - Jerrold Kohn, 4944 Washington, 68506	488-4547
Treasurer - Ralph Ulrich, 441 Jeffery Drive, 68505	434-6757
Board Member - George E. McGinnis, 3444 Somerset Ave., 68504	466-4878
Board Member - Frank Rule, 6333 Kearney, 68507	466-0453

APPOINTMENTS:

Liaison Officer - Mrs. Marie Taylor, 910 New Hampshire, 68508  
Historian & By-Laws - Mrs. Frances Tracy, 3601 South Street  
Librarian - Mrs. Dorothy Engelhart, 4130 Witherbee Blvd.  
Program, Mrs. Marie J. Carveth, 2526 So. 11th St., 68502  
Hospitality & Guest Book - Mr. & Mrs. Ewald Paul  
Education - Gene L. Eno, Phone 423-6157  
Refreshments - Mr. & Mrs. Lynn Wells, Phone 435-6758  
Scholarship Coupons & Commemorative Stamps - Helena Baegl  
1968 Show Chairman - Larry Rupert, 351 So. 26th St. Ph. 435-6069  
Publicity for Show & Club in 1968 - Mr. & Mrs. Bruce Simon, Ph. 423-2984

Other appointments to be announced as they are made.

BULLETIN STAFF:

Editor - Phyllis Parks, 2435 So. 19th St., 68502, Phone 423-6798  
Assistants - Mrs. Norma Miller and Jim Parks  
Club News - Mrs. Marie J. Carveth, 432-9100  
REPORTERS - ALL Club Members

Articles published in THE PICK AND SHOVEL may be reprinted if credit is given and a copy of the publication is mailed to the editor.

\* \* \*

affiliated with

MIDWEST FEDERATION OF MINERALOGICAL AND GEOLOGICAL SOCIETIES

AMERICAN FEDERATION OF MINERALOGICAL SOCIETIES

Editor - Member National Bulletin Editors Association

# NOTICE

NEW meeting place - W.O.W. Meeting Hall  
734 So. 27th St.

Time - 7:30 P.M. April 27, 1968

PROGRAM: "CABS AND SLABS"

Our program this month is to be given by two professionals in their field, Maurice Tracy and John Lewis. This will be an informative talk, with some specimens to show procedures in the cutting and polishing of rough materials into the finished cabochon ready for mounting. Maurice, a former instructor in the lapidary, and John, who is presently conducting the classes at the City Recreation, will give us a good program. Questions and answers will be welcomed.

-Marie J. Carveth, Program Chairman

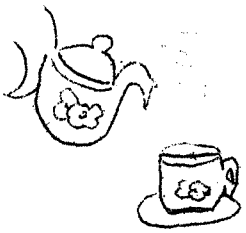

The REFRESHMENT committee which so carefully took care of our needs at the March meeting were Gene Eno, Dorothy Engelhart and The Webers. The cookies and coffee were very fine and what a pleasant surprise to have the delicious "Silver Anniversary" cake shared by Perry & Norma Miller. We thank you all.

Those participating in the April REFRESHMENTS will be Earl Amen, Helena Baegl, and Mr. & Mrs. Irl Everett.

submitted by Mr. & Mrs. Lynn Wells, Chairmen

## CORRECTIONS FOR YOUR 1968 "WHO'S WHO"

Add new member-Mr. Paul Greenwade, 1934 So. 33rd St. 68506  
Phone 488-1939

Correct this address -Bob Fast, 1801 Adams, 68521

In your Library Section-List MINERALOGY FOR AMATEURS by John Sinkankas rather than Gemstones & Minerals. (Sorry I listed it incorrectly the first time.)

FIELD TRIPS for April: 14th Annual Rock Show, Hastings City Auditorium, 4th St. & Hastings Ave., presented by the Central Nebraska Rock & Mineral Club. They will have casting demonstrations by the Southwest Smelting Inc. of Dallas, Texas, which should prove very interesting, in addition to their usual fine show. Hope to see many of you there.

Nebraska Barbed Wire Collectors Association will have their second annual wire and hobby show at the National Guard Armory, McCook, Nebr. on April 27-28. Our own Judy and Everett Weber and Irl Everett will be involved in the activities there and you might find several things to enjoy.

SUMMER VACATION ANYONE??? The editorial staff will take a breather by printing only a small bulletin in June and perhaps a page or two only in July and August to keep you informed of activities that you will want to participate in. We also will be doing some printing for publicity on the ROCK SWAP and 1968 SHOW.

**NEW MEETING PLACE:** As you know Roberts Dairy Party Room will no longer be available for us to hold our meetings. Everyone was asked to make any suggestions for places which might accommodate our club's present membership. Each of these leads was very carefully checked and evaluated by the Board of Directors and the Chairman in charge and a complete report made to the club. At the March meeting their final report was made and a recommendation by the Board that we rent the WOW Hall at 27th and Randolph Streets. This seemed to them the most favorable as it could be secured with a contract permitting us to use in monthly on our regular meeting night; it has a nice kitchen, two rest rooms, air conditioning; ample chairs and tables if we desire to have a covered dish supper; and a room which we can use for the storage of our club properties under the same roof. The Board made a complete tour of the hall before making their recommendation. After some discussion and a motion to table the decision until a later time (which was dismissed by the majority of the members voting) a motion was made to proceed with the renting of this meeting site for the following year, seconded and approved. Thanks should go to all those who took the time and effort to help locate a suitable meeting site and to all those who made suggestions of any sort, as it is only in this way that an organization can succeed.

THANKS should go to Mr. Bill Moore for the slides of our Rockrama which he so generously gave for our club library and that we were privileged to see at our February club meeting. THANKS also to Mr. & Mrs. Ralph Ulrich for sharing their wonderful trip to Europe with us. It must have been an interesting and colorful trip.

MARCH register showed a total of 62 members present and 4 visitors- Mrs. Glenna McGinnis, Mrs. Doris Rule, Miss Hazel Bigley and Mr. R. E. McCall.

DOOR PRIZES: Six numbers were drawn and the lucky recipients of such nice materials as Montana agate, Brazilian agate and Indian moss were: Mrs. F. S. Lange, Bill Schneider, Mrs. Fred Claus, Lloyd Lederer, Lloyd Baugher and Chester Bagg. We see these prizes made up into lovely displays for our 1968 Show. Congratulations!

#### ACTIVITIES CALENDAR

May 18-19	Cedar Valley Rocks & Minerals-All-Iowa Round-Up, Marian, Iowa So. Dakota 5th Annual State Show, Hot Springs, So. Dak.
Fri. May 17	Creative Craftmakers' Show, Gateway Center Auditorium
June 8-9	3rd Annual Show, Siouxland Gem & Mineral, Sioux City, Iowa State Line Gem & Mineral Society Rock Swap, Wauseon, Ohio Rocky Mountain Federation Show, Tulsa, Okla.
June 14-16	Wyoming State Show, Lander, Wyo. (Eden Valley trip????)
July 25-27	Ishpeming, Mich. Rock & Mineral Club Show
August 17-18	Northwest Nebraska Rock Show, Crawford, Nebr.
August 22-25	Combined American Federation-Midwest Federation Show and Convention, Normal, Illinois
Sept. 13-15	Nebr. State Rock Fair, Lincoln County Fairgrounds, sponsored by the Platte Valley Rock & Mineral Society.
Sept. 28-29	Lincoln Gem & Mineral Club 10th Annual Show, Pershing Aud.

Flyers and other information on most of these events will be available at the club meetings or through your Liaison or Editor. A few of them will be inserted in your membership bulletins as we receive. Be sure to ask for competition or display information for any shows that you may be able to attend.

Fellow Rockhounds,

Spring is here and before too long we will be itching to make a field trip or two. Let your board know what places you think are good for rocking, then they can set up plans for the club field trips.

Our show chairman tells us that our show plans are coming along fairly well and before too long they should be completed.

From last reports the Rock Swap & Picnic plans are nearly completed. Let us all make plans to attend and make this the best one yet. We have so many out of towners that come and we should all try to be there to make them feel welcome. I'm sure every member has a little something to trade with fellow rockhounds. If you don't have anything to swap come anyway and enjoy the great outdoors.

I want to thank all members that helped make our club display at the Hobby Show a success. We were awarded a very nice certificate for participating.

I was pleased to see so many members at our last meeting. It gave them the privilege to vote on the new location of our club home. The April meeting will be held at the new location. It is the W.O.W. Bldg., located at 27th and Randolph. It is on the east side of 27th Street and just north of the furniture store. Our calling committee will notify all members in regard to the new location for our April meeting.

Don't forget door prizes will be given again but you must attend the meeting to win one of them.

Sincerely,

Howard Taylor

## COMMITTEE CHAIRMEN FOR 1968 SHOW

General Show Chairman - Larry Rupert

Publicity & newspaper adv.	Mr. & Mrs. Bruce Simon
Programs	Mr. & Mrs. Lloyd Baugher
Treasurer	Mr. Ralph Ulrich
Memory table	Mrs. Howard Taylor
Traffic mgr. & floor plan	Mr. G. W. McKinney
Machine shop	Mr. Frank Rule
Black light display	Mr. Norman Engelhart
Rock Swap	Mr. Geo. McGinnis
Education (club appointed)	Mr. Gene Eno
Radio & television adv.	Mr. Perry Douthit
Advance tickets	Mr. Jerry Kohn
Club center display	Mrs. Marie Carveth
Club case co-ordinator	Mr. Ewald Paul
Registration	Miss Helena Baegl
Come & go	Mr. Wm. Schneider
Security	Mr. Robt. Bainbridge
Club displays, visual aids, etc.	Mrs. Dorothy Engelhart
Special features	Mr. Irl Everett
Outdoor signs	Dewey Rupert

Other appointments announced as made.

At last years show many of our club members were heard to ask what we could do this year to equal last year's rockrama: The only possible thing we can do is roll up our sleeves, go to work and put on the usual fine show for which our club is noted.

The Lincoln Gem and Mineral Club has never taken a back seat to any other club in this area. With your continued cooperation we shall not do so this year.

Larry Rupert - Show Chairman

ROCK SWAP: Chairmen Mr. & Mrs. George McGinnis.

Lincoln Gem and Mineral Club's third annual Rock Swap will be held at the Boy Scout Camp, 1st and Van Dorn on August 3 and 4. We can guarantee that the more of you who participate the more fun everyone will have. Numerous plans are being made and flyers will be off the press very soon for you to start passing out to your friends and fellow rockhounds over the area.

## HISTORY NOTES OF TEN YEARS AGO

The members and guest of the Lincoln Gem and Mineral Club enjoyed a visit to the Planetarium. This was arranged for us by Dr. C. Bertrand Schultz.

Leland Pavel, Willard Haas, Robert Bainbridge, Mr. & Mrs. Tom Simmons were introduced as new members.

Mrs. Tracy reported on the fine show at Hastings and that the Hastings club members would like to work with our club, as well as the other Nebraska clubs, in organizing a Nebraska show in 1959.

-from the Historian's Notebook

\* \* \*

NOTE OF APPRECIATION to Mrs. Frances Tracy for her excellent historical portrayal of our Lincoln Gem and Mineral Club's first 12 years. A more complete yet concise document could not have been conceived and we are certain it will meet with great favor by our club members and by the Midwest Federation at whose request this project was carried out. One copy will go to the MWF Historian, Mr. Russell P. McFall for filing in the MWF Archives at the Field Museum in Chicago. One copy went to our club library for membership reference and one to the Historian's files for posterity. We hope everyone will take the opportunity to look briefly into our club's permanent history.

\* \* \*

## ADVERTISEMENT

## Everett Lapidary Shop

2941 North 65th St.

Phone 466-6204

A P R I L      S H O W E R S

bring you the BEST BUYS from

"THE CAPITOL CITY'S FIRST ROCK SHOP"

Our stock is large.

Our prices are fair.



SATISFIED

CUSTOMERS ARE OUR BEST

ADVERTISEMENT

DEFENSE OF A FRIEND...

This past week it was my good fortune to witness a heart-warming display of kindness by the many people involved in the defense of a friend. We can talk about "involvement" and "non-involvement" but you never really are aware of your true feelings until you really become "involved" in a cause. I am referring to the hearing at the State Capitol of the State Game Commission and John Kurtz, Superintendent of Fort Robinson.

After the horrible events that have happened recently (rioting, burning, looting and worst of all, the needless assassination of Dr. Martin Luther King, Jr.) it was just great to be "involved" in the defense of John Kurtz. And the best part of this situation was that John was there to hear it all. Many times, as in the case of Martin Luther King, it takes a tragedy before many people will speak of the good accomplished by someone, and usually that someone is no longer among the living and able to hear the eulogies so grandly stated.

Fortunately this was not the case on April 11. In this instance John and his wife were present and heard the many kind and friendly words spoken. The Senate chamber was filled with people who chose to become "involved" in the defense of their friend. Many only gave name and address and went on record supporting John. (Marie Taylor and I fell in this category). Many others, local and out-state, spoke long and eloquently in his favor. (Included in this last category were our own Tom Simmons, Everett Weber and Irl Everett.) I had to leave the meeting before hearing Everett and Irl speak but I am sure they summed up their statements as well as Tom, who spoke on behalf of Lincoln Gem & Mineral Club in tribute to John.

It was truly a heart-warming experience to witness so many unsolicited people willing to state their loyalty and go on record in support of a friend.

N. Miller

\*\*\*\*\*

DIAMOND PUZZLE FOR THE "KIDS"

Fill in the blanks according to the definitions below:

- Part of the mouth
- Jewel that comes from oysters
- A diamond is called a precious \_\_\_\_\_
- A single unit

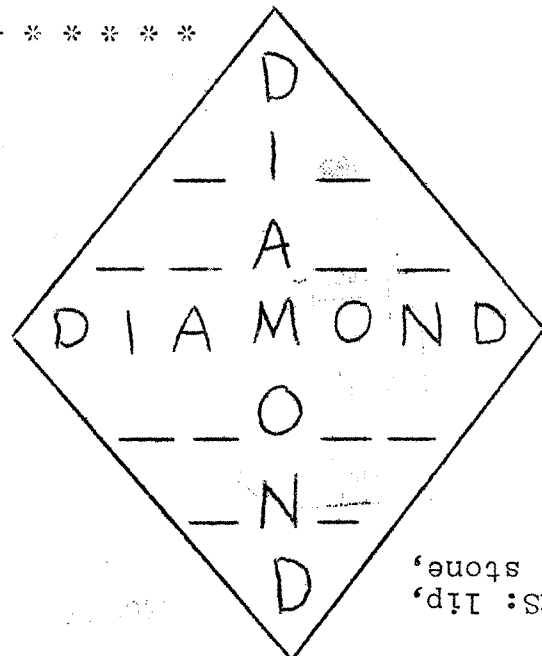

(via THE ROCKETTE-bulletin of Mid-Iowa Rock Club, Marshalltown, Ia.

ANSWERS: 1ip, pearl, stone, one.

## Y O U N G     V I E W P O I N T



It's April. The time of spring fever, rock shows and field trips on weekends.

And speaking of April, we know someone who reaches that magic age of 16. The thrill of getting behind the wheel for that 'really' first time. Congratulations go to Ricky Kohn!

I was reading in a magazine an article entitled "On the Rocks." Here it is for you. "Mexican lace jade, goldstone and other pebbles are netting Cindy Farnham, age 17, of Pittsburgh, Pennsylvania, an annual income "in five figures." What started her out? A 2-pound bag of shiny pebbles for a Christmas gift. She opened up her own rock shop, "Cindy's Rock Shop". She tumbles the stones and makes them into jewelry."

Wouldn't it be nice if one of our club members could do something like this? How about it?

That's all for this month, so until later!

Susie Taylor, Junior Reporter



-----

THE STORY OF THE HYMN "ROCK OF AGES CLEFT FOR ME...."

This is not fancy or imagination, but a fact. The hymn was written by a clergyman, Augustus Montague Toplady, who was born in 1740 A.D. and passed away in 1778 A.D. Little else is known regarding him, or when the hymn was actually written, but this is known for certain. Along the high and rocky coast of England near the town of Burlington in Somersetshire, there is a notably high rock roughly 500 feet straight up in the air. The clergyman, when a young man, had attended a night meeting in the village and after the meeting, he walked back to his home. Suddenly, a terrific thunderstorm came up and the only place he could find for shelter was a cleft (or cave) in this huge old landmark in which he took shelter during the storm.

While waiting in this refuge, the story goes, Augustus Toplady wrote this famous hymn and also composed the music.

-Irving Hurlbut via Chips off the Old Rock  
of Mineral Club, Inc.

-----

Know why a rabbit likes diamonds:     They're measured in carrots!

via Gem Time, Las Vegas Gem Club

## INVITATION FROM ALASKA...

## ...ALASKA TO EASTER ISLAND via SOUTH AMERICA GEM FIELDS

Join the first gem and mineral tour of Easter Island (Rapa Nui) land of the giant statues. Only archaeologist tours have been there before. The Chugach Gem and Mineral Society of Anchorage, Alaska, welcome you on this first tour.

Here on the most isolated of Polynesian islands are found the fascinating remains of a culture that built 70 foot high statues, roads, great quarries, petroglyphs, living caves. Rongo Rongo boards were their written language.

Easter Island has unexplored beaches for agate hunting, water filled with tropical fish and lobster. Boats and fishing and skin diving equipment are available for hire. We will fish for lobster by torchlight and eat a Polynesian "Sau-Sau" feast, while lovely girls, dressed in their traditional chicken feather dresses, will dance and sing for us. Cars will take us to the statues, etc. for exploration.

Easter Island temperature is year round about 70 degrees F. Carved sculptures can be purchased.

On equipment to take, I suggest hiking boots, light raincoats, slacks, rock hammer, chisel, and a few small plastic containers for gems. Baggage allowance from Chile to Easter Island is 33 lbs., otherwise in South American 44 lbs. Take plenty of film for pictures of the 8th wonder of the world.

Air fair is \$1850.00 from Los Angeles, \$1972.00 from Seattle, \$2072.00 from Anchorage, Alaska. This also covers the finest hotels, meals while traveling. This is more than 25% cheaper than normal fare and includes the 4600 miles from Chile to Rapa Nui.

Early reservations are requested as tour membership is strictly limited to the availability of hotel accommodations. Deposit of \$400.00 by June 1st will hold any reservation. The balance is due Sept. 1st. Full refund will be made up to that time, after which refund will be amount paid less any cancellation fee.

## YOUR FLIGHT ITINERARY:

- Oct. 4. Leave Anchorage, Seattle, Los Angeles for Bogota, Columbia, South America.
- Oct. 6. Field trip to famed Chivor Emerald mines.
- Oct. 8. Lima's museums have invaluable treasures. We will visit the Government palace that stands on original site of LaCasa de Francico, where the "Conqueror of the Incas" was shot down. We will visit Pizarro's remains, the Court of the Inquisition, the Gold Museum of Sr. Gallo, the fortress of Pachacama.
- Oct. 9. Leave Lima for Cuzco. We'll visit the Temple of the Sun and a pre-Columbian collection of Inca treasures.
- Oct. 10. Take train to Machu Pilcchu, secret city of the Incas.
- Oct. 13. Leave Santiago, Chile for Easter Island.
- Oct. 14, 15, 16. Easter Island field trips.
- Oct. 17. Leave Easter Island, arrive Santiago.
- Oct. 21. Sao Paulo tour of Lapidarist workshops. View Isuassu Falls
- Oct. 24. Tour gemstone shops, meet gemstone wholesalers.
- Oct. 26. Belo Horizonte field trip for crystals of hematite, beryls, brazilanite.
- Oct. 27. See exquisite collection of gems and minerals and leave leave for Governador Valadares.

(continued next page)

ALASKA TO EASTER ISLAND (continued)

Oct. 28. Leave on field trip for green tourmaline, topaz.

Oct. 29. Charter Bus for Conganhas and Ouro Preto, area rich in topaz, copper, malachite, azurite, and dolomite.

Oct. 30. Field trip for gem pegmatites; return to Belo Horizonte

Nov. 1. Leave Rio for Los Angeles.

Howard Robinson Travel Agency, operator of the tour outlined, has been conducting Alaskan tours since 1952. Also has offices in Juneau and Seattle, also.

Please enclose airmail postage on additional inquiries, which should be addressed to Mrs. Oro Stewart 531 - 4th Ave., Anchorage, Alaska. 272-3531.

(Editor's Comment...The above is only a partial list of events to take place on this tour but we have listed the field trips and places of interest that would be attractive to the gemologist and rockhound. A complete itinerary is available in our files and will be at club meetings.)

\* \* \* \* \*

HAPPINESS is a lot like jam; when you spread it, you usually end up getting some on yourself.

HAPPINESS is like an amoeba - it multiplies by division.

\* \* \* \* \*

ADVERTISEMENT

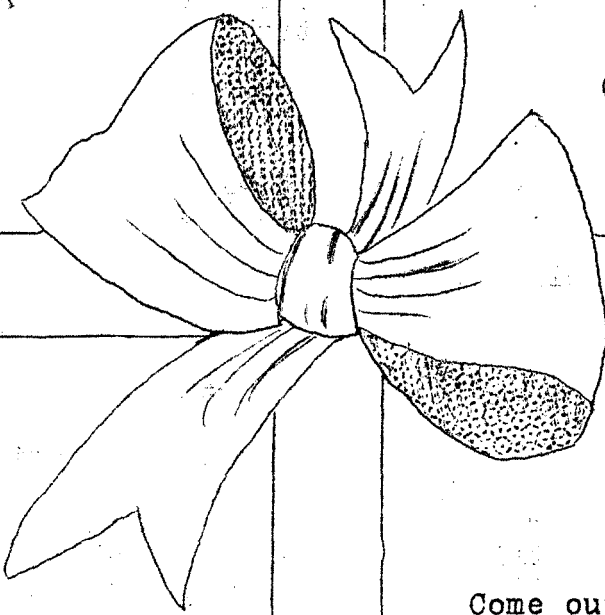
<p>FOR MOTHER</p> 	<p><b>CLAUS</b> LAPIDARY and CERAMICS</p> <p>2639 West O Street</p> <p>Phone 435-2300</p> <p>Open 3:00 until 10:00</p> <p>See our huge selection of materials before buying MOTHER'S DAY GIFTS.</p> <p>Come out and visit "The Do-It-Yourself Shop"</p>
---	---

## DES MOINES, IOWA VISITORS

After making a date (in the winter time) ahead in early spring, the weather - one keeps hoping for the best.

Saturday was bikini weather. It was a little cool in the morning so everyone was a bit warmly dressed, but the material found at Behren's was quite nice. The visitors from Iowa had some nice Nebraska material to add to their collections.

Late afternoon we proceeded to the Old County Quarry, nice to get away from the clouds of dust for they were working at Behren's. Some went up on the cliff wall, some headed to the north end, one or two headed south, then there were those who headed west and just sat in the shade of the wall and yakked, and encouraged the others to keep sending more goodies down.

Zelma Woody was the gal on the bucket that kept descending down the wall. When they were finished digging up above someone was going to jump and let her catch them. She was game, chicken or should I say rooster.

Irridescent calcite, barite, druzy quartz, calcite, fossils, were the finds on Saturday. Saturday evening, cake, coffee, rockswapping, snooping around at the House of Krafts, feather flowers, taper lamps, some nice material and trades both ways.

About ten, called it a day. For most the first time out this spring found us all ready to hit the sack, too much fresh air and warm sunshine.

Our house guests The Woodys and the MacNamars, and us the Engel-harts, just tumbled into bed, in fact, we didn't even hear the two alarms go off Sunday morning.

Had a call or two saying that they would be late, seems they had the same problem we did, good sound relaxing sleep.

Weeping Water bound, for fossil, it was a day for long handled underwear. A north wind did blow, everyone was trying to find a place to hunt out of the wind.

Marie Wells, Lincoln, found the goodie of the day, a crown, but it couldn't have happened to a nicer gal.

Everyone piled into their cars and headed for Springfield to Mr. Sass's new museum and rock shop, Mr. Sass's museum is a rockhounds dream come true. It is a lovely place, a wonderful display of artifacts, minerals and other fascinating specimens.

All too soon it was time to say our goodbyes and leave for home.

-Dorothy Engelhart

Editorial Comment: Would like to add that the weekend celebration was also a rockhound's birthday delight. Before leaving for Des Moines a cake with a history of travel, sharing and planning was finally cut and served. The birthday gal was Dottie herself -not revealing the years- but enjoying every minute of it. Many more happy ones to you with lots of rockhound years left. pnp

## DID YOU KNOW - - - -

When this issue of our "Pick and Shovel" is read, all of the Easter finery will have had its initiation in the fashion parade Easter morning. May it be a happy time for all.

John Lewis, and the midnight ride, with Lillie playing chauffeur, to Bryan Memorial Hospital, proved to be a short stay for our friend. A kidney stone attack quite painful, John is now improving and back in the daily routine.

The Weber family will drive to McCook, Nebraska to attend a state-wide meeting of the Nebraska Barbed Wire Clubs. Judy is making her appearance as the Nebraska Queen. Nice trip, Ruth, Judy and Everett.

Dr. & Mrs. Lange are busy in their yard making ready for another lovely garden. The result -- their beautiful and colorful flowers are proof of many long hours spent out in "Lange's Acres."

Recently, at Northeast High School, the "Rocket Revue" was presented. Again, young people, members of our own Lincoln Gem and Mineral Club, made a fine showing with their many talents. Terry Weber, a senior, played in the band, and also worked hard as stage manager. Terry is the son of Mr. & Mrs. Everett Weber. Aldy Lewis did a magnificent job in the part he played as the owner and operator of the "Girl-Creating Computer". Reports are this skit brought down the house! Aldy used his fathers famous "instant Cabochon Machine". Aldy is the son of Mr. & Mrs. John Lewis. Aldy's sister has played with the Lincoln Community Playhouse, she is a talented actress. The George McGinnis' daughter Debbie was also a member of the Rocket Revue. We are happy and proud of these "Young Americans", nice to have you in our club!

The Lincoln Hobby Show is now over and our L.G.M.C. made a good showing with sixteen cases being displayed.

Ralph and Kay Ulrich will have spent a long week-end with their daughter, Lois Metzger and family at Cape Girardeau, Missouri, an Easter holiday for them.

Mr. & Mrs. J. D. Young have a house guest! One of our most famous people, namely Dr. John Neihardt, Poet Laureate of Nebraska. Dr. Neihardt is writing his autobiography. This book when published will indeed be a treasure to those of us who have the honor to know this great man. At present, Dr. Neihardt is in the state of Missouri making several appearances at the University of Columbia. Here, the dedication of his library, a private collection of approximately five thousand volumes, some extremely rare. Dr. Neihardt has some twenty-five published books to his own credit. Also, at this time a bronze bust of Dr. John Neihardt will be dedicated.

On April 12, Dr. Neihardt will receive the Thomas Jefferson awards of 1968, this being the highest award the University of Missouri presents to any individual. Branson, Missouri is also on the agenda, this is "Shepard of the Hills" country - Dr. Neihardt is a special guest at the Rose O'Neil celebration - it is the "Kewpie-iesta". Miss O'Neil is the creator of that famous doll the kewpie doll. At Taney Hills, Dr. Neihardt attended a library luncheon in his honor.

(continued)

DID YOU KNOW ---(continued)

With the coming of spring, Mr. & Mrs. Young look forward to traveling to Bison, South Dakota, with Dr. Neihardt. Thirty years ago he spoke at high school commencement exercises there. Now the school wishes him to speak at their sixtieth. More on the activities of our Poet-Laureate later, but here I shall add - Such wonderful friends Dr. Neihardt has in Mr. & Mrs. J. D. Young!

Marie & Virg Carveth entertained eight friends with a dinner party Monday evening; a farewell gesture, the young couple being honored are transferred to Rapid City, Dakota. A real rock hunters paradise!

Until next time

Marie J. Carveth

\* \* \*

Diamonds may be a girls best friend now, but the gems were strictly a male adornment until a few centuries ago. Prior to the 15th century only kings and exalted churchmen wore diamonds. 'I am happy this condition changed in our favor' -----mjc

ARE DIAMONDS RARE BECAUSE OF WHAT THEY ARE MADE? - No, diamonds are made of carbon - one of the most common and familiar elements in the earth. They are rare because of the way they are made. To become a diamond the carbon must be trapped in molten lava; the lava must have a certain chemical composition; and the heat and pressure surrounding the diamond must be tremendous. These conditions are hard to duplicate by man-made devices. It has been done, and diamonds have been made synthetically - but the process is too expensive for diamond-making to be a profitable activity.  
-source unknown

\* \* \*



A late note of sympathy to Mr. & Mrs. Robert Bainbridge and family in the loss of Millie's father, Mr. George Eirick.

The Homestead Gem and Mineral Club of Beatrice received this message from their President, Mr. Robert Maxon. Since it so appropriately expresses the views of Lincoln Gem & Mineral club members we take the liberty of printing it:

A Tribute To A Great Little Man -

By this time most members are aware that Glen Hawkins passed away on April 3rd. It is a great loss throughout the community and to the many rock clubs which he belonged to. Glen was a great asset to any rock club or organization. He knew rocks from A to Z and could identify most specimens and give a short rundown on them from memory. He has influenced several people in rocks and minerals in which he was proud to be associated with. Glen & Ruth's spheres are known the nation over for being outstanding in this field of rocks. He will always be remembered by all of us as a good friend and fellow rockhound."

-The Pioneer

TURQUOISE AND SILVER - 3rd in a series on Indian Silver & Crafts

From the late 1890's until 1938 the Hopi Indian Silversmiths followed the traditions of the Navajo and Zuni work.

However, in 1938 the program instituted by the Museum of Northern Arizona encouraged Hopi smiths to develop a style of silver work based on their very distinctive pottery designs and executed in an overlay technique. "Hopi Silversmithing, Its Background and Future" is a good book to study on this type silver work. Overlay is a silverworking technique in which two sheets of silver are used. The design is cut out of one with a jeweler's saw and overlaid on the solid piece. The two pieces are then "sweated" together. A torch is used to "sweat" the cutout portion onto a solid sheet of silver. The bottom portion is then turned black with liver of sulfur to make the design stand out. After shaping and polishing, the finished piece gives the appearance of having been carved from a sheet of heavy silver. The Hopi does not, today, use turquoise in the silver work.

Another art of the Hopi Indian culture are the Kachina Dolls. This doll plays an important role in the religious training of the children. There are some 250 Kachinas and it may refer to many things the children will learn in life. These dolls are not idols and are not worshiped or prayed to. The Hopi men carve Kachina dolls from the root of the cottonwood tree; using a knife and a rasp, the painting was once from earth pigments, now commercial poster paints offer a wider range of color.

The Hopi tribes also do beautiful wicker basket weaving, as well as pottery-both the cooking-ware type to the more decorative pieces.

submitted by Marie J. Carveth

ADVERTISEMENT

# SIMMONS

R E N T A L   &   L A P I D A R Y

2970   South   Street

Phone 488-1619

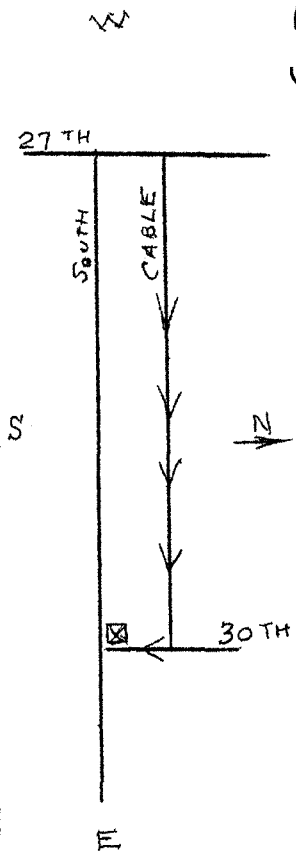

South Street may be closed to nearly all traffic but Tom will be open if you need anything. Just come via the streets north and east of 27th and South until you see his place. The welcome mat is out.

# Midwest Federation's NEWSLETTER

Published monthly except July & August as a Service to Member Clubs.  
Editor: Haydon Peterson, Route 5 - Box 229, Des Moines, Ia. 50317



---

Issue No. 84 - April 1968

---

## IT'S OUR BIG SHOW

-by June Culp Zeitner

Now is the time for all of us to make plans to attend our big Gem and Mineral show in Normal, Illinois from August 22 through 25. True, the Corn Belt Lapidary and Mineralogical Society of the Bloomington-Normal area is host club, but all the rest of the nearly 200 Midwest clubs are hosts too, for this is Our Big Show. The Midwest Federation, like the other 5 Federations, has an opportunity once every 6 years to be host to the National Gem and Mineral Show, the official show of the American Federation of Mineralogical Societies. Our last National show (in 1962) was at Des Moines, Iowa where the brilliant work of the Des Moines Lapidary Society earned us a reputation which will be hard to improve. It is up to all of us to help make this year's show the outstanding success that the Des Moines show was.

First we can help with our attendance. Since it is our annual official Midwest Convention as well, we can take part in the activities of Our Federation. We can enhance the Midwest's name by being truly friendly to all of our guests from other Federations. We can learn about competitive displays by taking our best work. The new rule booklet is simple and easy to follow. Any of our displays which win our Regional Competition will also be eligible for National competition. Even if we don't think our personal display will win, there is much to be learned from competition, besides showing that we are 100% behind OUR SHOW.

If we help with our presence, our displays, our hospitality, and our participation in Federation activities we can all take pride in OUR SHOW, but more than that we will make new friends, learn more about our hobby, and have a wonderful time we will never forget.

The special displays for the National Show are some which you have seen pictured on Lapidary Journal covers, and in Gems and Minerals and Earth Science. There will be rocks and gems from every

State in the Union. There will be the fabulous gold goblets and chalices of Bart Mann, a hobbyist whose work is so good he received a White House commission. You will see a miniature working model of an oil rig made of highly polished obsidian. The priceless ivory elephant, encrusted with gold and hundreds of precious stones, will be a special display from the Lizzadro Museum. You will see flowers made of stone, looking so lifelike that even a bee could be mistaken. You will see hand made gold jewelry, and have a chance to see how it is made. There will be rare fossils, perfect artifacts, exquisite carvings, mosaics and intarsias. There will be displays of some of the finest minerals from the Smithsonian.

Skilled hobbyists and Manufacturers will have demonstrations, and dealers from all parts of the nation will offer the newest and best in all the fields covered by the earth science and lapidary arts hobby. The swap area will give you a chance to build up your own collection by trading your good excess specimens for someone else's good duplicates.

You will see movies, slides, hear instructive lectures by National authorities, attend the bulletin seminar, the banquet, and other special events. You'll receive information about where to stop for field trips on the way back home. In short there will be something for everyone at OUR SHOW. Let's make it one we will always be proud of.

## CORRECTION

In our March issue under the article "Index of New and Discredited Mineral Names" by Margaret Yanasak, the issue of the American Mineralogist you should ask for when writing should have read, Vol. 51, No. 8 (August 1966).

---

Help Eliminate Litter Please

## PENNIES FOR SCHOLARSHIP

An old motto states that "A penny saved is a penny earned". We feel sure that no sane rockhound would throw pennies in the wastebasket and yet this is happening every day. When you toss that empty General Mills cereal box into the garbage without saving that 2-point coupon on the top you are throwing money away. EVERY Betty Crocker coupon point is worth 1/2¢ to the Scholarship Foundation so that 2-point coupon on the cereal box is worth one penny. Please do save the coupons and send them to us.

The Midwest Federation has sent in over 235,000 coupons - more than any of the other Regional Federations so some of you are saving those coupons. In glancing through our Midwest record book we find that almost one-third of our clubs have never sent in a coupon.

Our congratulations to the Wabash Valley Gem and Mineral Society upon attaining their 200% statue. Since February 1964 this club has sent in almost every single month without fail a contribution and a batch of coupons. Sometimes maybe only 10 or 12 coupons, sometime several hundred. This regular collection of their pennies and coupons at every single meeting has paid off for them and made them 200% without any big hard work money making projects.

We only have 59 non-participating clubs now as against 88 as of April last. If each of these clubs as well as some of our other clubs would stage a coupon drive it would help their status. We wish every club would participate but as our wise treasurer says... "no one owes the Foundation a gift - rather the donor owes it to himself to support this project which has done so much to improve the public image of the rockhound". Thanks to all of you for your support.

-Katharine Steinbrenner

## THE SPRING MEETING

of the Midwest Executive Committee will be held in Terre Haute, Indiana in conjunction with the Vigo Rock and Gem Club of Terre Haute on April 20-21 in the Science Building of the Indiana State University. The Executive meeting will be on Saturday, April 20, in room 108 of the Science building beginning at 9:00 A.M.

## SCHOLARSHIP FOUNDATION FOUNDER DIES

Harry L. Woodruff, Past President of the American Federation and one of the organizers and a Past President of the Eastern Federation, passed from among us on January 2nd last, in Pasadena, California. We lost a great friend, but one who will live on in our memory, especially for his wonderful contribution to our hobby world.

That the American Federation establish a Scholarship Foundation was his idea. It was first presented for consideration in 1958, and a committee appointed to study it. When Harry Woodruff presented the report of this committee at the annual meeting of the AFMS in Portland, Oregon, on September 4, 1959 it was enthusiastically received. Instructions were to begin solicitation of funds immediately. Mr. Woodruff announced he already had the pledge of \$100 from the Gemcrafters of Miami, the first society to contribute. Mr. Howell Lovell presented \$20, the first individual to contribute. And the Foundation was on its way!

Getting the news around was a laborious task in the beginning, with few clubs having club bulletins then. The going seemed slow. Five years later less than \$4000 had been collected. Some seemed to feel we might not reach the first goal of \$50,000 to get a student started from earnings of the fund. But there were others who didn't doubt it. The word was getting around. Each year brought new contributors and more repeaters.

Harry Woodruff never lost faith in his idea, and often expressed the wish that he might live to see our first goal a reality during his lifetime. He did see this dream realized. First there was a student at the University of Colorado; then the second at Harvard University, and the third at the University of Georgia. This year we hope to start two students.

---

## STILL AVAILABLE

Exhibitors Manuals at 25¢ per copy. Uniform Rules at 15¢ per copy. Approved Reference List of Gem Names at 10¢ per copy. Write Tolson Radloff, 625 Winchester Avenue, Lincoln Park, Michigan 48146 if interested.

## COMPETITIVE DISPLAYS IN GEM AND MINERAL SHOWS

Each of us as members of Gem and Mineral Societies seek certain satisfactions. Some wish only to find recreation in field trips or to collect and possess minerals and fossils. Some wish to share the materials collected and the products of their lapidary skills through the medium of shows and exhibits.

We recognize there are always responsibilities attendant upon privileges. It is a privilege to collect from nature's store-house, and to use this material in making jewelry or other useful and ornamental objects. In doing this, we acquire both material and information, and therein lies the responsibility of sharing with others.

We can certainly state that a primary purpose of all exhibits and of all shows is to Learn and to Share.

As in the other fields of business and industry, in which we take proper pride in our American progress and accomplishments, growth and development have been largely due to competition.

This is, and has been, true of competition in Gem and Mineral displays. Competitive exhibits, because they are competitive, set the standards of excellence and bear the burden of establishing and maintaining educational values and of upholding a public image worthy of those associated in Earth Science societies and federations. Without accepting the responsibility of Learning and Sharing through our shows, we would soon become pack rats or bower birds.

So we engage in competitive shows, and our winning efforts become Special Exhibits much in demand by non-competitive chairmen, not only to aid in growth and development of knowledge and skills, and to uphold a public image worthy of our opportunities, but because of public demand and approval.

The public, those that attend events and pay money for the privilege, appreciate competition. They love a winner. Hundreds attend an exhibition game but thousands attend when a pennant is at stake. No exhibit attracts attention like the one with a ribbon or trophy.

I am not saying that the non-competitive exhibits are not important, for this is not true. In these, we find the beginning from which future competitive exhibits may be built, and all should have the opportunity and satisfaction of displaying collections and workmanship. We find the need for entertainment and amusement acknowledged in non-competitive exhibits in clever and original ways. These displays are essential, and the ones that can put a smile on a solemn face should have preferred billing and placement. However, those who can prepare and display competitively, should very definitely do so.

The basis of all competitive exhibits is The Regional and Local Uniform Rules prepared by the regional rules chairmen for use in 1967-68-69. There are both editing and printing errors in the original printing which have been corrected by a single sheet. Both the Rules and the correction sheet are available from your Midwest Rules Chairman, Mr. Tolson Radloff, 625 Winchester, Lincoln Park, Michigan 48146. Order these, and the List of Approved Gem names, as amended, through the secretary of your society so that bulk shipments may be made. Unfortunately the Exhibitors Manual is out of print and also in need of revision. Part IV of this manual dealing with showmanship, is still very timely. The remainder contains so much that is now obsolete that all sections except only Section IV pages 4 to 13 are applicable. The list of Mineral Names and discredited mineral names will be available shortly. These were published in the August issue 1966 of the American Mineralogist. Possibly you can find a copy for present use.

These rules and lists are not prepared to read through beginning with page 1 etc. Those who are planning to exhibit in a division, (such as minerals) will turn to the index under "divisions" and find the proper pages. Very little attention need be given to the other pages except only as references are made to specific sections.

So you have chosen your Division. Next you will choose the class. These are all set out clearly on your chosen division page.

The exhibitor group in which you will exhibit must then be chosen. Exhibitor Groups, as shown in the index, are on page 7, # 37. In effect this says that you may not enter in a group LOWER than the one in which you have won ribbons, but you may, if you choose, enter a higher group. A beginner, if he feels he has a display capable of scoring high points, may enter in the Master Group the first time he exhibits. This is frequently done since all National Trophies are given only to winners from either Junior or Master Groups. Novice, advanced, dealer, and society groups are eligible only for ribbons. No Junior nor Master group exhibitor need make an entry for National Trophy. Since the rules are identical for both regional and national competition, his exhibit is automatically entered for a trophy when he enters the Regional competition of any show where National Trophies are offered. If you find any Trophy rules in conflict with Regional rules, mark them "printing error", and refer to the correction Sheet. THE REGIONAL RULES AND REQUIREMENTS APPLY.

We are much pleased to hear that many of our societies are forming Rules Study groups. This will accomplish two results: First, the members will become better informed through group reading and discussion, and, from such a study may come much needed suggestions for improvement of the rules, both in content and in wording. Any suggestions or recommendations should be passed on to your Regional Rules Chairman.

We can see no need of further discussion of the rules at this time, so shall give you our findings and conclusions from attendance at National Shows during the past six years.

The greatest weakness in competitive exhibits, and equally the greatest opportunity for exhibitors, is in Educational and Society Exhibits.

First; Educational Exhibits: Our index states that Rule # 71, pages 15 and 16 are to be used. This is Division E, and, as are all other DIVISIONS, it is open to all exhibitor Groups (Including Societies). The limiting rules of quality, rarity, and workmanship, do NOT apply. Also, there are no limitations on the use of synthetics or casts, or extraneous material useful in pursuing the educational values.

I find some apparently do not know what an educational exhibit is. The display must first have a specific purpose (and title) quite similar to those our young people use for their science fair projects. You choose your educational subject, use charts, printed or typed explanations, pictures, if necessary to your purpose, but always keeping in mind accuracy in labels and attractiveness in appearance. The classes offered cover all the divisions and the rules are non-restrictive in order to permit freedom of imagination and originality.

We have been asked for suggestions as to subjects for development into educational projects. Here are a few: Pseudomorphs, the Mineral Mimics; Ammonites, Past and Present; Evidence of Fossil Origin of Geodes; The Systems of Crystallization; Twins and Striations in Minerals; Petrification and Petrifying Agents, etc. Once you get the idea, you can think or one much better than any I have suggested. Please remember this is a Division and is open to ALL exhibitor groups. Trophy Award # 14 is offered for Master entries.

Next; Societies at one time were limited to stated classes. Now, every class in every division is available to them. The regular rules of each division apply, and 37 - D on page 7 is absolutely clear as to what constitutes a Society Exhibit. There is nothing to prevent your Society from entering in more than one class if you so choose. It would be a wonderful experience for a number of people. Just another word: Always have someone check your spelling. As to showmanship: this is the Artistic sense of arrangement of size and color so that the whole effect is pleasing. One "odd duck" no matter how good a single specimen, should be left in the home pond, if he would lessen your score.

Each society has a definite responsibility to its members who wish to increase their knowledge and abilities. The study of standards as shown in the rules, is one of them. Since each division uses wording applicable to its own subject, these terms should be a part of the special study. To some,

the words variety, species, genus, epoch and period, formuls, etc., are just words. You who know their meaning can remember the time when you did not know. Those working with minerals and those with fossils, should have study workshops. We find the lapidary people have done a better job than the others in becoming familiar with terms, but, even so, we find clubs, the members of which do not know the difference between lapidary and jewelry.

Another responsibility of societies is to teach the rudiments of showmanship. We visited a local show a few years ago and were impressed by the unusual appeal and arrangement of so many of the exhibits. We felt certain this was not an accident. Inquiry led us to be introduced to a lady who was an art teacher. She had been coaching others in the club. Expert window dressers, especially those from jewelry stores are excellent teachers. The artistic sense can be developed.

After the fear of Rules and of categories and exhibitor groups have all been dispelled by familiarity and understanding, and everything is properly labeled and a diagram of the best arrangement has been prepared, how do you enter the show?

You will write to the exhibits Chairman, or better, your rules leader will do this for all exhibitors in your club. You will write to: Mr. William Eaton, Box 334, Normal, Illinois 61761, and request entry blanks. You will receive these together with a certificate for an officer of your club to sign attesting your club membership and amateur status. After this is all completed we will see you at Normal, Illinois, August 22-23-24-25, 1968. You will be among good company, Rockhounds from all over America.

Merton A. Young, Chairman  
American Rules Committee for 1968.

ROCKHOUND POEM

I WISH I HAD A FIND-O-SCOPE  
TO TELL WHERE TREASURE LIES:  
BUT SINCE I HAVE NO FIND-O-SCOPE  
I'M GLAD I HAVE TWO EYES.

I WISH I HAD A "WHIRLY-BIRD",  
ROCK HUNTING WOULD BE SWEET;  
BUT SINCE I HAVE NO "WHIRLY-BIRD"  
I'M GLAD FOR MY TWO FEET!

I WISH SOME WHEELS WERE UNDERNEATH  
THIS HEAVY OLD ROCK SACK;  
BUT SINCE SUCH GIMMICKS ARE UNKNOWN  
I'M GLAD FOR MY STRONG BACK.

TWO EYES TO SEARCH FOR TREASURE,  
TWO FEET TO TAKE ME THERE;  
A BACK TO TOTE THE HEAVY SACK-  
WHY, I'M A MILLIONAIRE !

By Domer Howard, "Sooner Rockologist"  
via The Gem News, No. Las Vegas, Nevada

\* \* \*

What a grandmother is.

" A grandmother is a lady who has no children of her own, so she likes other peoples little girls. A grandfather is a man grandmother, he goes for walks with boys, and they talk about fishing and tractors and like that.

Grandmas don't have to do anything except be there. They are old, so they shouldn't play hard or run. It is enough if they drive us to the market where the pretend horse is and have lots of dimes ready. Or if they take us for walks they slow down past things like pretty leaves or caterpillars. They should never say "Hurry up".

Usually they are fat, but not too fat to tie the kid's shoes. They wear glasses, and they can take their teeth and gums out. It is better if they don't typewrite or play cards except with us. They don't have to be smart only answer questions like why dogs chase cats or how come God isn't married.

They don't talk baby talk like visitors do, because it is hard to understand. When they read to us they don't skip words or mind if it is the same story again. Everybody should try to have one, especially if you don't have television, because grandmas are the only grown ups who have got time."

This contribution is from the Georgia Dept. of Public Health and written by Patsy Gray, age 9. We copied it from The Prairie Gem, a quarterly bulletin which we receive from The Prairie Rock & Gem Society of Regina, courtesy of Mr. W. Goodwin, Bulyea, Sask., Canada.

Also this tip: Try a piece of the new "indoor outdoor carpeting" glued on your polishing wheel. It's waterproof and gives a nice polish with cerium or tin oxide.

And: Experience is something that when you finally have it, you are too old for the job.

From

LINCOLN GEM & MINERAL CLUB  
% Mrs. Phyllis Parks, Editor  
2435 South 19th St.  
Lincoln, Nebr. 68502



TO

Mr. & Mrs. Maurice Tracy  
3601 South Street  
Lincoln, Nebr. 68506

SAVE GENERAL MILLS COUPONS - Worth one-half cent for scholarhiip.

COMMEMORATIVE STAMPS - Aid Refugee Children.

USE CLUB AND FEDERATION EMBLEMS - STICKERS - PATCHES

"UNITED WE STAND" - Motto from Ellis W. Courter, MWF President

H E L P    E L I M I N A T E    L I T T E R    P L E A S E

August 22-23-24-25, 1968 - THE AMERICAN-NATIONAL ROCK SHOW to be  
held in conjunction with the MWF at Normal, Illinois.